



GRIFFIN
THE PROPERTY PEOPLE



Dudley Close

Chafford Hundred, Grays, RM16 6PG

Guide price £95,000

**** GUIDE PRICE £95,000 - £110,000 **** NO ONWARD CHAIN ****
CASH BUYERS ONLY ****

We are pleased to offer for sale this ground floor STUDIO flat situated within this popular road of Chafford Hundred.

The property itself is only open to CASH BUYERS, but does benefit from having a good sized lounge and bedroom area, shower room, parking and is also offered with NO ONWARD chain. Call the sales team today....

Viewing

Please contact our Grays Sales Office on 01375 397872 if you wish to arrange a viewing appointment for this property or require further information.

- Ground Floor
- Lounge/Bedroom Area
- Shower Room
- Viewing Advised
- No Onward Chain
- Cash Buyers Only
- EPC: C78



Floor Plan

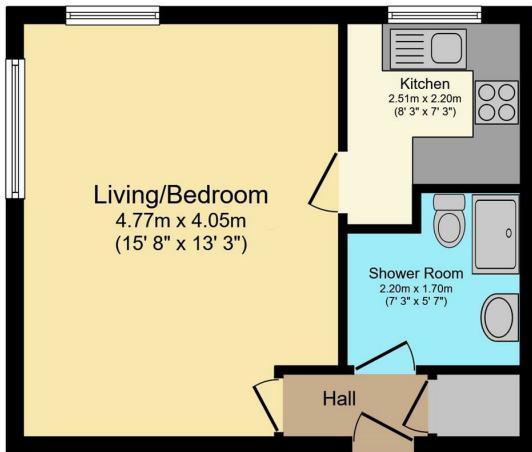

Area Map



Energy Efficiency Graph

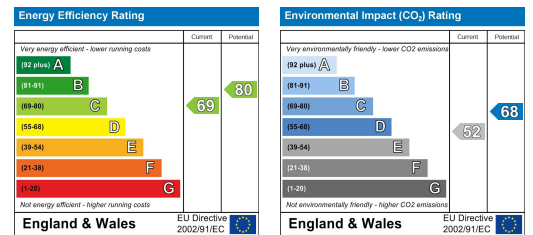

Total floor area 33.0 m² (355 sq.ft.) approx

This floor plan is for illustrative purposes only. It is not drawn to scale. Any measurements, floor areas (including any total floor area), openings and orientation are approximate. No details are guaranteed, they cannot be relied upon for any purpose and they do not form part of any agreement. No liability is taken for any error, omission or misstatement. A party must rely upon its own inspection(s). Powered by www.focalagent.com

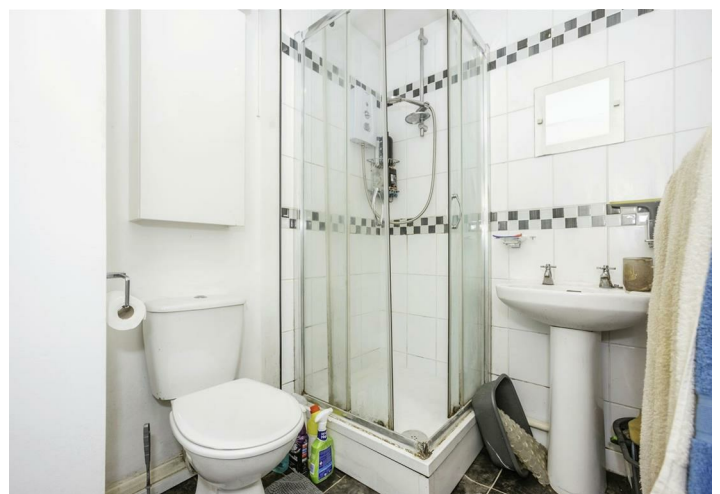

These particulars, whilst believed to be accurate are set out as a general outline only for guidance and do not constitute any part of an offer or contract. Intending purchasers should not rely on them as statements of representation of fact, but must satisfy themselves by inspection or otherwise as to their accuracy. No person in this firm's employment has the authority to make or give any representation or warranty in respect of the property.