



# GRIFFIN

THE PROPERTY PEOPLE



## Dennises Lane , South Ockendon, RM15 5SD

Asking price £375,000

\*\*\*\* GUIDE PRICE £375,000 - £400,000 \*\*\*\* GATED DEVELOPMENT \*\*\*\* TWO BEDROOMS \*\*\*\* UPMINSTER BORDERS \*\*\*\*

We are delighted to offer for sale this TWO BEDROOM property situated on this popular GATED DEVELOPMENT which is on the borders of Upminster and being ideally placed for access to South Ockendon train station which is on the Southend to London Fenchurch Street C2C line, Golf courses, and Junctions 30/31 of the M25.

The property itself benefits from first and second floor bedrooms and shower rooms, open plan lounge/kitchen/diner, rear garden, and parking to the front in the landscaped communal area which is accessed via the security gate at the entrance to the development. This really is a lovely development and property and we would therefore recommend viewing at your earliest convenience to avoid certain disappointment.

- House
- End Of Terraced
- Open Plan Lounge/Kitchen
- Allocated Parking
- Gated Development
- Wet Room
- En-Suite to Main Bedroom
- Viewing Advised
- EPC: C79

### Viewing

Please contact our Grays Sales Office on 01375 397872 if you wish to arrange a viewing appointment for this property or require further information.



2



2



1



C

## Floor Plan

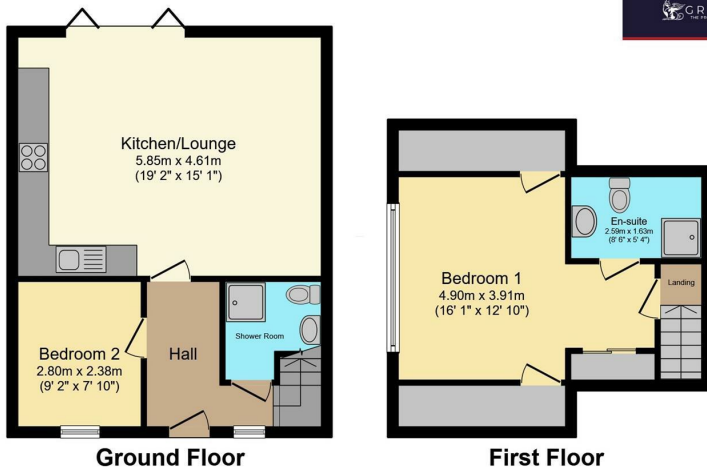

## Area Map



## Energy Efficiency Graph

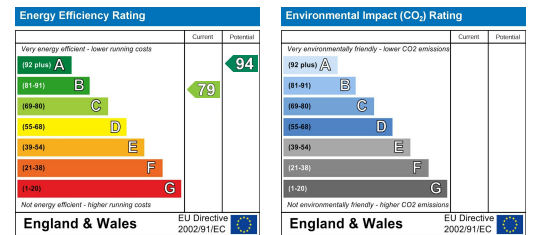

Total floor area 72.7 m<sup>2</sup> (782 sq.ft.) approx

This floor plan is for illustrative purposes only. It is not drawn to scale. Any measurements, floor areas (including any total floor area), openings and orientation are approximate. No details are guaranteed, they cannot be relied upon for any purpose and they do not form part of any agreement. No liability is taken for any error, omission or misstatement. A party must rely upon its own inspection(s). Powered by www.focalagent.com



These particulars, whilst believed to be accurate are set out as a general outline only for guidance and do not constitute any part of an offer or contract. Intending purchasers should not rely on them as statements of representation of fact, but must satisfy themselves by inspection or otherwise as to their accuracy. No person in this firm's employment has the authority to make or give any representation or warranty in respect of the property.