



26 Ashdale Road, Nottingham – NG3 7BD

Guide Price £210,000 – £220,000

DavidJames
the estate agent



26 Ashdale Road

Nottingham, Nottingham

GUIDE PRICE £210,000 - £220,000 Three bedroom semi-detached home with potential for modernisation, offered with no upward chain. Spacious rooms, driveway and garage plus a convenient location close to schools and amenities!

Council Tax band: B

Tenure: Freehold

- Generous semi-detached home with huge potential
- Walking distance of a number of local amenities and public transport links
- Offered to the market with no upward chain
- Large lounge with a feature gas fire
- Second reception room (ideally suited as a dining room with patio doors to conservatory)
- Fitted kitchen with integrated cooking appliances
- Three good-sized double bedrooms
- First floor bathroom with a four-piece suite
- Low maintenance rear courtyard with useful workshop and storage outbuildings
- Driveway providing off-street parking and garage access







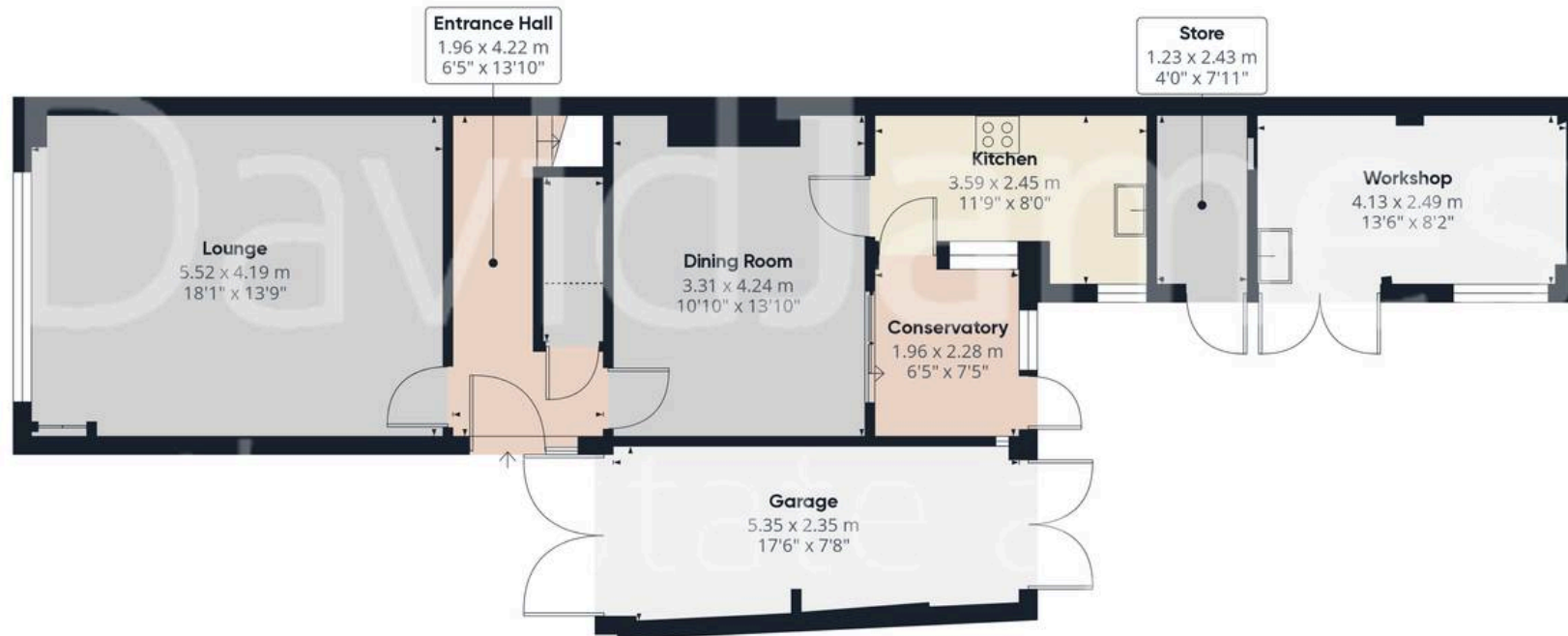

Floor 0

Approximate total area⁽¹⁾

125.17 m²

1347.31 ft²

Reduced headroom

1.09 m²

11.78 ft²

(1) Excluding balconies and terraces

Reduced headroom

..... Below 1.5 m/5 ft.



Floor 1

While every attempt has been made to ensure accuracy, all measurements are approximate, not to scale. This floor plan is for illustrative purposes only.

Calculations were based on RICS IPMS 3C standard. Please note that calculations were adjusted by a third party and therefore may not comply with RICS IPMS 3C.

GIRAFFE360



David James Estate Agents

376 Carlton Hill, Carlton - NG4 1JA

0115 987 8957 • carlton@david-james.com • www.david-james.com

These particulars are produced in good faith and are set out as a general guide only. Measurements are approximate and floor plans are for illustrative purposes only. Services have not been tested. We have established professional relationships with third-party suppliers for the provision of services to Clients, details of which can be found on the property listing page on our website.