



 3

 2

 1

 E

DavidJames
the estate agent

Hillcrest Grove, Sherwood, Nottingham, NG5 1FT

Guide Price £220,000

About This Property

GUIDE PRICE £220,000 - £230,000 Welcome to this extended semi-detached home, available with no upward chain and brimming with opportunity and potential! Located in a sought-after cul-de-sac in Sherwood, this property is just a short stroll from the exciting array of nearby eateries, bars and shops as well as frequent bus services to Nottingham City Centre, ensuring convenience is at your doorstep.

Initially, you'll find an entrance hall, complete with handy understairs storage. The good-sized lounge features a large bay window that floods the room with natural light whilst adjacent you'll find a versatile dining room that can adapt to your lifestyle needs. The fitted kitchen has a range of units which incorporate space for freestanding appliances and also provides access to a convenient downstairs WC.

Upstairs, three well-proportioned bedrooms await, with both the main and second bedroom having the added advantage of fitted wardrobes. The complementing family bathroom is then equipped with a three-piece white suite and an electric shower.

Outside, the enclosed lawned rear garden is southerly-facing and a blank canvas ready for you to imprint your own style. The shared driveway to the front leads to a detached garage providing an additional storage solution.

- Extended semi-detached house
- Popular cul-de-sac location close to Sherwood's amenities
- Offered to the market with no upward chain
- Good-sized lounge and a separate dining room
- Fitted kitchen with space for freestanding appliances
- Ground floor WC
- Three bedrooms
- Bathroom with a three-piece white suite and an electric shower
- Enclosed southerly-facing lawned rear garden
- Shared driveway leading to a garage which provides useful storage







Floor 0

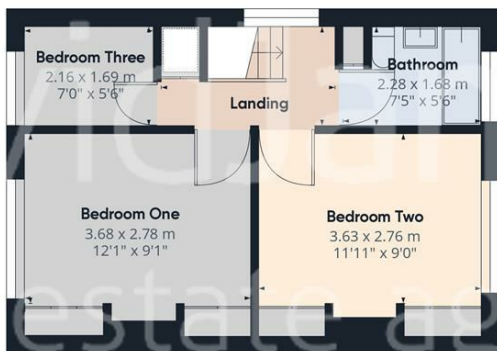

Floor 1



Approximate total area*

78.42 m²
844.15 ft²

Reduced headroom

0.5 m²
5.39 ft²

(†) Excluding balconies and terraces

⚠ Reduced headroom
(below 1.5m/4.92ft)

While every attempt has been made to ensure accuracy, all measurements are approximate, not to scale. This floor plan is for illustrative purposes only.

GIRAFFE360

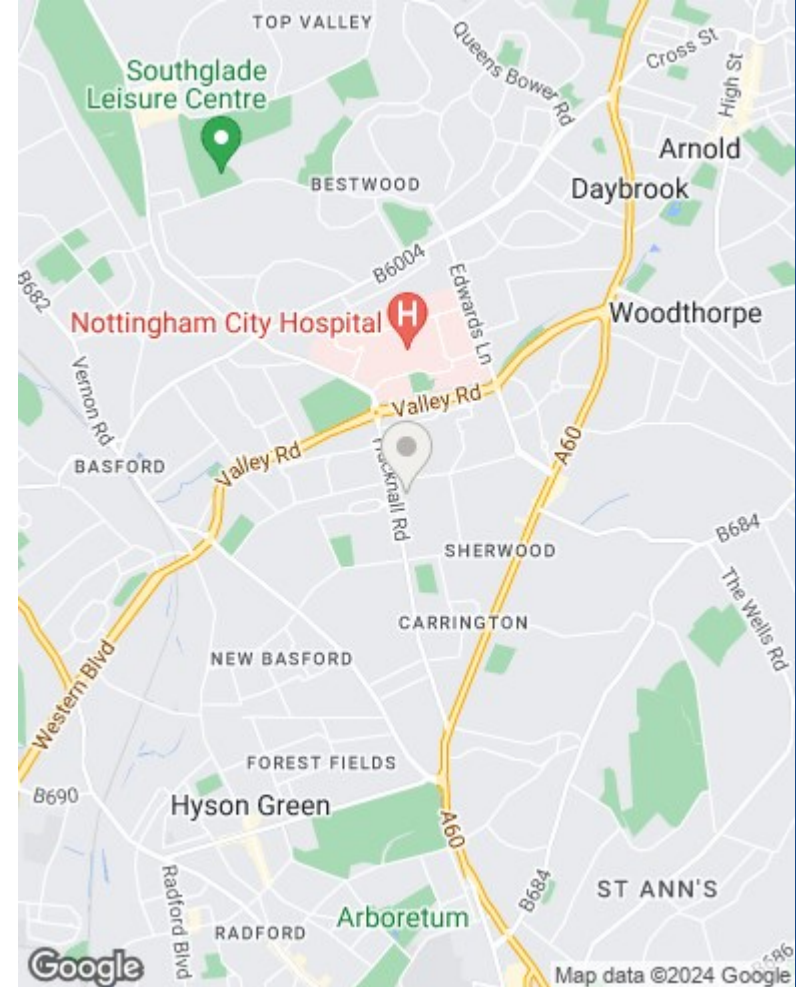

These particulars are produced in good faith, are set out as a general guide only and do not constitute any part of a contract. No person in the employment of David James Estate Agents Ltd has any authority to make any representation whatsoever in relation to the property. All services, together with electrical fittings or fitted appliances have NOT been tested. All the measurements given in the details are approximate. Floor plans are for illustrative purposes only and are not drawn to scale. The position and size of doors, windows, appliances and other features are approximate only. The photographs of this property have been taken with a 10mm wide-angle lens. No responsibility can be accepted for any loss or expense incurred in viewing. If you have a property to sell you may wish to take advantage of our free valuation service. David James Estate Agents have established professional relationships with third-party suppliers for the provision of services to Clients. As remuneration for this professional relationship, the agent receives referral commission from the third-party company. David James Estate Agents receives the following commission from each third party supplier on a per referral basis: W A Barnes Ltd: £60 including VAT. All Moves UK Ltd: 18% including VAT of the invoice total (£107 including VAT average). MoveWithUs Limited: £188 including VAT (average).

Council Tax Band: B
Nottingham City Council
Freehold

DavidJames
the estate agent

David James Estate Agents
100 Front Street, Nottingham, NG5 7EJ
t: 0115 955 5550 e: arnold@david-james.com

