



 2

 2

 2

 D

DavidJames
the estate agent

Haydn Road, Sherwood, Nottingham, NG5 2JU

Guide Price £175,000

About This Property

This period-style semi-detached house in Sherwood offers a blend of traditional features and modern convenience. The property includes two double bedrooms, with the main bedroom featuring an en-suite bathroom complete with a white suite and an electric shower. The lounge, a highlight of the home, boasts a cozy fireplace and beautifully stripped and varnished floorboards, leading into a separate dining room. The galley kitchen is designed with ample storage units. Additionally, there's a convenient ground floor shower room with a mains shower, a Wc and a washbasin located in the rear lobby. The home benefits from combination gas central heating and UPVC double glazing, ensuring year-round comfort. There is also a cellar. Outside, the rear yard features a planting bed and makes a nice seating area in the summer months. Located within walking distance to the shops and amenities of Sherwood and sold with no upward chain, this house is perfectly positioned for both convenience and lifestyle, making it an attractive option for potential buyers looking for a home with character and accessibility.



DavidJames
the estate agent

- Period style semi-detached house
- Two double bedrooms, bedroom one with en-suite bathroom/Wc with white suite and electric shower
- Lounge with fireplace and stripped and varnished floorboards
- Dining room with access to a cellar
- Galley kitchen with a range of units
- Ground floor shower room/Wc with mains shower and washbasin set in the adjacent rear lobby
- Combination gas central heating, UPVC double glazing
- Rear yard with planting bed
- In walking distance of Sherwood's shops and amenities
- Sold with no upward chain



DavidJames



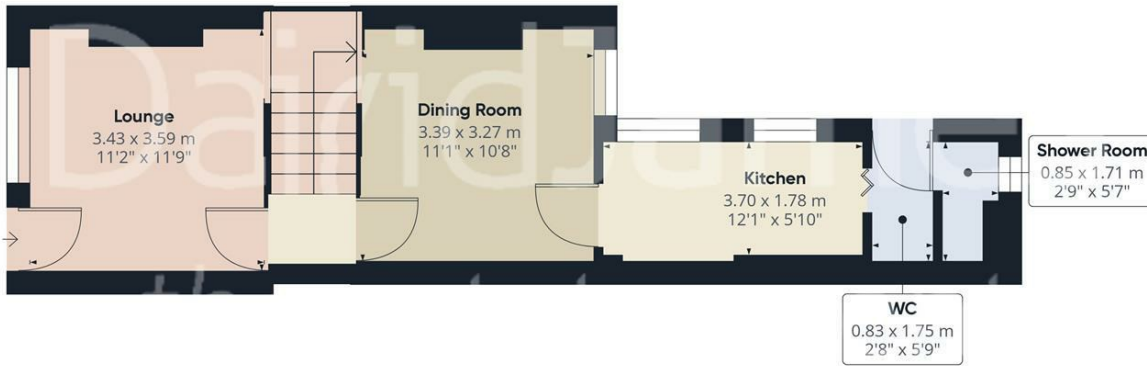

Floor 0



Floor 1



Approximate total area**
62.48 m²
672.49 ft²

(*) Excluding balconies and terraces

While every attempt has been made to ensure accuracy, all measurements are approximate, not to scale. This floor plan is for illustrative purposes only.

GIRAFFE360

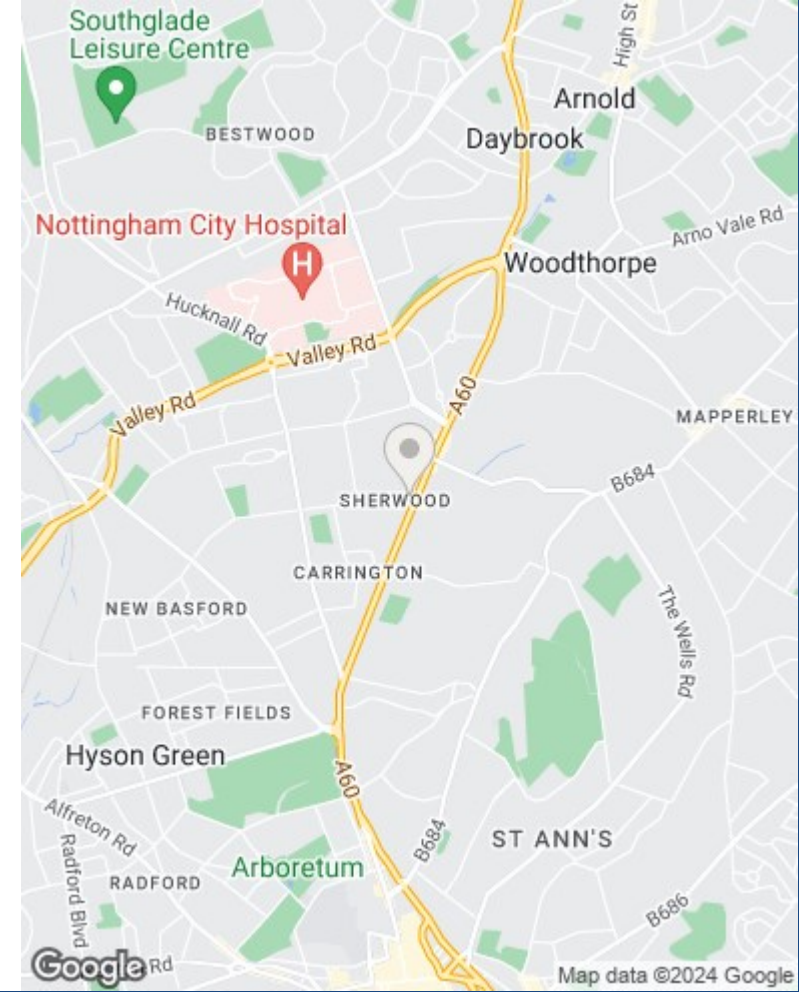

These particulars are produced in good faith, are set out as a general guide only and do not constitute any part of a contract. No person in the employment of David James Estate Agents Ltd has any authority to make any representation whatsoever in relation to the property. All services, together with electrical fittings or fitted appliances have NOT been tested. All the measurements given in the details are approximate. Floor plans are for illustrative purposes only and are not drawn to scale. The position and size of doors, windows, appliances and other features are approximate only. The photographs of this property have been taken with a 10mm wide-angle lens. No responsibility can be accepted for any loss or expense incurred in viewing. If you have a property to sell you may wish to take advantage of our free valuation service. David James Estate Agents have established professional relationships with third-party suppliers for the provision of services to Clients. As remuneration for this professional relationship, the agent receives referral commission from the third-party company. David James Estate Agents receives the following commission from each third party supplier on a per referral basis: W A Barnes Ltd: £60 including VAT. All Moves UK Ltd: 18% including VAT of the invoice total (£107 including VAT average). MoveWithUs Limited: £188 including VAT (average).

Council Tax Band: A
Nottingham City Council
Freehold

DavidJames
the estate agent

David James Estate Agents
100 Front Street, Nottingham, NG5 7EJ
t: 0115 955 5550 e: arnold@david-james.com

