



## Woodlea Drive

Bromley, Kent BR2 0UG

*A thoughtfully extended and absolutely stunning 3-4 bedroom detached house*



## 33 Woodlea Drive

Guide Price £1,000,000 - £1,050,000

A thoughtfully extended and absolutely stunning 3-4 bedroom detached house located in a quiet residential road just a short walk from local shops at Westmoreland Road.

Downstairs the property boasts a lovely open plan style kitchen/dining/living room with full width bi-fold doors leading onto a raised patio overlooking the 100' + garden to the rear. To the front there are 2 further reception rooms one accommodating a handy office with ensuite shower and wc and another snug/bedroom 4.

Upstairs the bedrooms benefit from built in wardrobes and there is a superb 4 piece family bathroom.

There is further potential, subject to planning permissions, to extend to the rear first floor and side.

Langley Park secondary schools and Pickhurst Park are close by with Bromley South station with fast services to London approximately 1 mile away. For viewing arrangements please call Ian Browne

- 3/4 bedrooms
- 24'10 open plan kitchen/diner
- Office
- Downstairs shower/wc
- Snug/bed 4

- Stunning bathroom
- Ample storage cupboards
- Extension potential (STPP)
- Private parking
- 108' garden







Woodlea Drive, BR2

Approximate Gross Internal Area  
1472 sq ft / 136.7 sq m

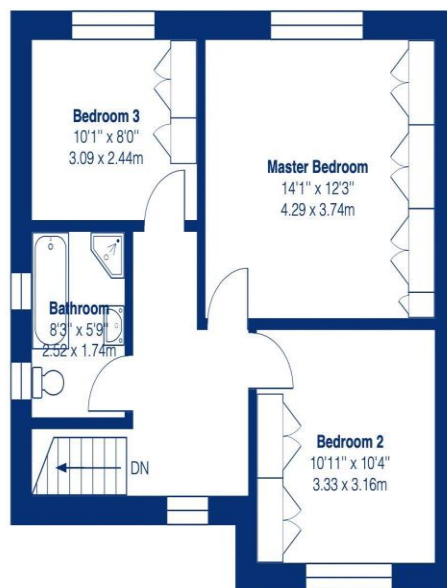

This plan is for layout guidance only and not drawn to scale unless stated. Window and door openings are approximate. Whilst every care is taken in the preparation of this plan, we would advise interested parties to check all dimensions, shapes and compass bearings prior to making any decisions reliant upon them.  
By Homeoutlook.co.uk / Copyright 2025

#### Disclaimer

We have not tested any services, systems or appliances at this property. We strongly recommend that all the information which we provide is verified by yourselves on inspection, and by your Surveyor and Conveyancer.



## Additional Information

**Council Tax Band: F**

**EPC Rating: D**

**Location: Bromley**

**Viewing: Via Browne Estates**

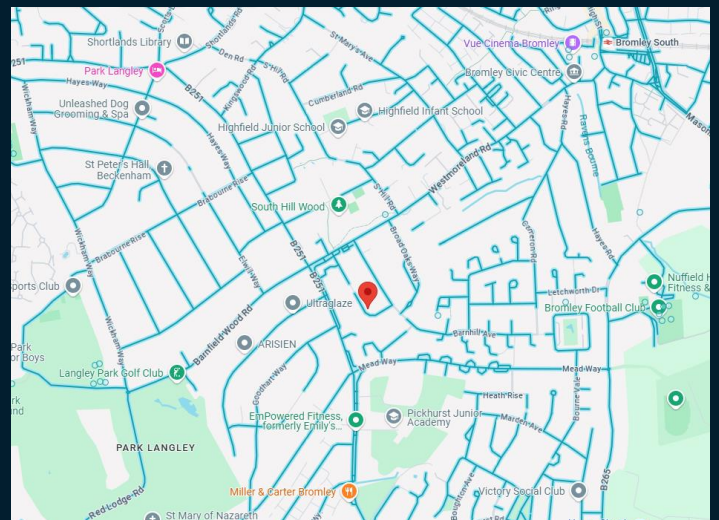
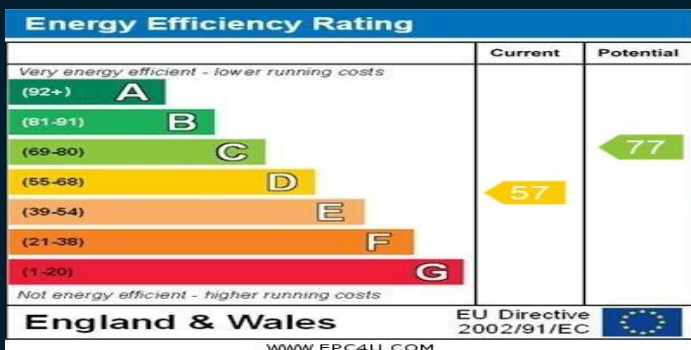

197 Widmore Road, Bromley, Kent BR1 2RG

Email: [sales@browne-estates.co.uk](mailto:sales@browne-estates.co.uk)

Tel: 020 8466 9101

[www.browne-estates.co.uk](http://www.browne-estates.co.uk)