

Estates

# Browne

**B**  
**E**

SALES & LETTINGS



## Union Road

Bromley, Kent BR2 9SB

*An extended 2 double bedroom Victorian semi-detached home*



## Union Road (Chatterton Village)

Price £599,950

Chain Free

Open Day: 14/7/2024

An extended halls adjoining 2 double bedroom Victorian semi-detached home located in the popular "Chatterton Village" with its array of local shops, restaurants and "The Chatterton Arms" public house.

Downstairs there is a beautiful through lounge/diner with a central period working fireplace, solid Oak flooring and a handy downstairs w.c.

To the rear there is a stunning kitchen/breakfast room with central island and a built-in wine cooler, a Bosch induction hob, oven, built-in fridge/freezer, dishwasher, underfloor heating and a utility cupboard with plumbing for washing machine and a combination boiler (with "Hive" controls) finished with bi-fold doors overlooking the lovely garden.

Upstairs there are 2 good sized double bedrooms and a stunning 4 piece bathroom suite with corner shower cubicle.

The area is well served for schools with Raglan Primary, La Fontaine, St. Georges, Bickley Primary, Southborough Lane, Bishops Justus Church of England, Bullers Wood Girls and Boys schools and Bromley High School all being close by. Bickley station is about ½ mile away and Bromley South station a little further.

Viewing absolutely essential!

- 2 Double bedrooms
- Through lounge/diner
- Kitchen/breakfast room
- 4 Piece bathroom suite
  - Downstairs w.c.
  - Cloaks cupboard

- Downlighters
- Skylight
- Underfloor heating
- Neutral decor
- 46ft Garden
- Alarm







Ground Floor



## Union Road BR2

Total Area: 95.8 m<sup>2</sup>... 1032 ft<sup>2</sup>

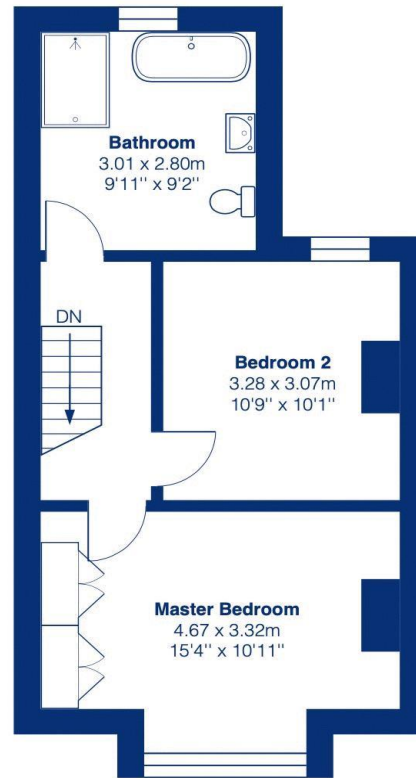

First Floor

This plan is for layout guidance only and not drawn to scale unless stated. Window and door openings are approximate. Whilst every care is taken in the preparation of this plan, we would advise interested parties to check all dimensions, shapes and compass bearings prior to making any decisions reliant upon them.

### Disclaimer

We have not tested any services, systems or appliances at this property. We strongly recommend that all the information which we provide is verified by yourselves on inspection, and by your Surveyor and Conveyancer.



**Additional Information**

**Council Tax Band: D**

**Location: Bromley**

**Viewing: Via Browne Estates**

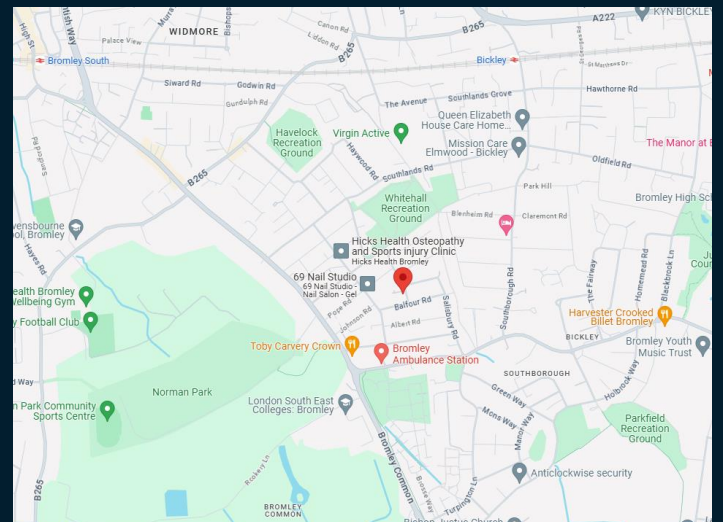

197 Widmore Road, Bromley, Kent BR1 2RG

Email: [sales@browne-estates.co.uk](mailto:sales@browne-estates.co.uk)

Tel: 020 8466 9101

[www.browne-estates.co.uk](http://www.browne-estates.co.uk)