



COCKBURN
ESTATE AND LETTINGS AGENTS

cockburn-online.co.uk

Horning Close, Mottingham, SE9

£230,000

🛏 1 🚿 1 🛋 1



- Chain Free Sale
- Well Proportioned Accommodation
- Quiet Location
- Great Buy to Let Investment
- Excellent Local Amenities
- Second Floor One Bedroom Flat
- Perfect For First Time Buyers Looking To Get Onto Property Ladder
- Gas And Central Heating
- Easy Reach Of Both Mottingham & Grove Park Railway Stations
- Council Tax Band B - London Borough Of Bromley



***** CHAIN FREE *****

Cockburn are delighted to offer for sale this one bedroom apartment that has been carefully maintained over the years, and offers a complete blank canvas for its new owners. The flat itself is set on Horning Close, a prime spot, that benefits from great transport links and open green spaces, alongside a permitted residents car park.



Horning Close, SE9

Approximate Gross Internal Area = 573 sq ft / 49.8 sq m

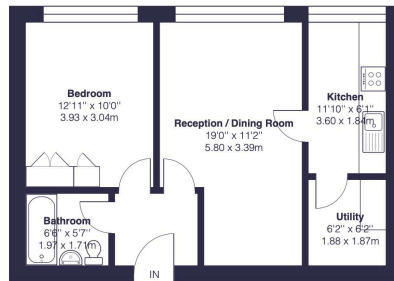

Second Floor



This plan is for layout guidance only and not drawn to scale unless stated. Window and door openings are approximate. Whilst every care is taken in the preparation of this plan, we would advise interested parties to check all dimensions, shapes and compass bearings prior to making any decisions reliant upon them.
By Homeoutlook.co.uk / Copyright 2025

Cockburn EA

352 Footscray Road,
London, SE9 2EB

t: **020 8859 8590**