



**COCKBURN**  
ESTATE AND LETTINGS AGENTS

[cockburn-online.co.uk](http://cockburn-online.co.uk)



## Belvoir Close, Mottingham, SE9

£270,000

3 1 1



- Three Bed Split Level Maisonette
- Private Balcony
- Ideal For First Time Buyers Or Buy To Let Investors
- Communal Gardens
- EPC Rating D - Potential C
- Offering Ample Space Throughout
- Close Proximity To Shops, Amenities & Green Spaces
- Excellent Transport Links Within Easy Reach
- Long Lease Length
- Council Tax Band B - London Borough Of Bromley





Cockburn present a great opportunity for either a Buy to Let investment, First Time Buyer, or as a family home - This three bedroom split level maisonette has bags of potential and would be perfect to get yourself on the property ladder.

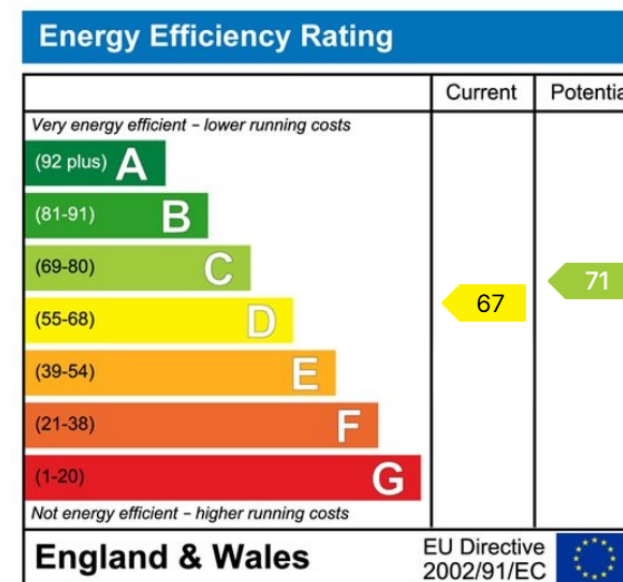
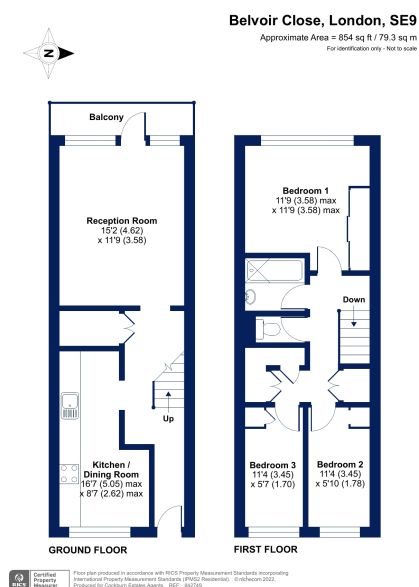

**Cockburn EA**

352 Footscray Road,  
London, SE9 2EB

t: 020 8859 8590