



Parkview Road, New Eltham, SE9

Guide Price £325,000

🛏️ 2 🚿 1 🚗 1



- Split Level Apartment
- Large Reception Room
- Garage En Bloc
- Close to Fairy Hill Park
- EPC - D
- Two Bedrooms
- Communal Gardens
- Excellent Transport Links
- Council Tax Band C - Royal Borough Of Greenwich



***** GUIDE PRICE £325,000 - £350,000 *****

Located in a popular Road and a short walk from New Eltham train station this split level apartment is ideal for first time buyers or buy to let investors.

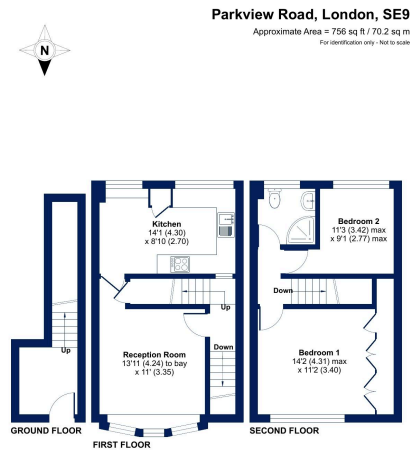

This plan produced in accordance with RICS Property Measurement Standards incorporating International Property Measurement Standards (IPMS) Residential. © Robinson 2024. Produced by Cockburn Estate Agents. REF: 1182396

9/16/24, 11:52 AM Energy performance certificate (EPC) - Find an energy certificate - GOV.UK

Energy performance certificate (EPC)		
2, Parkview Road LONDON SE9 2DA	Energy rating D	Valid until: 12 September 2034 Certificate number: 9199-3041-1201-8174-8209
Property type	Mid-terrace house	
Total floor area	61 square metres	

Rules on letting this property

Properties can be let if they have an energy rating from A to E.

You can read [guidance for landlords on the regulations and exemptions](https://www.gov.uk/guidance/landlords-property-conditions-property-conditions-energy-efficiency-standard-landlord-guidance) (<https://www.gov.uk/guidance/landlords-property-conditions-property-conditions-energy-efficiency-standard-landlord-guidance>).

Energy rating and score

This property's energy rating is D. It has the potential to be B.

[See how to improve this property's energy efficiency.](#)

The graph shows a vertical scale from A (top) to G (bottom). The current rating 'D' is marked with a yellow arrow, and the potential rating 'B' is marked with a green arrow. A 'Current' label is at the top and 'Potential' is at the bottom.

For properties in England and Wales:
 the average energy rating is D
 the average energy score is 50

<https://find-energy-certificates.service.gov.uk/energy-certificates/9199-3041-1201-8174-8209/property>

1/4