



# Court Farm Road, Mottingham, SE9

£800,000

🛏️ 5 🚗 2 🚗 2



- FOUR/FIVE BEDROOMS
- OPEN PLAN KITCHEN DINING ROOM
- BEAUTIFUL FRONT ASPECT
- CLOSE TO GOOD SCHOOLS
- LARGE GARDEN
- OUTBUILDING AND OFFICE
- OFF ROAD PARKING
- WALKING DISTANCE TO TRAIN STATION
- IDEAL FOR ELTHAM COLLEGE
- EPC RATING D



Spanning nearly 2000 square foot, this spacious and versatile well presented family home must be seen to be fully appreciated.

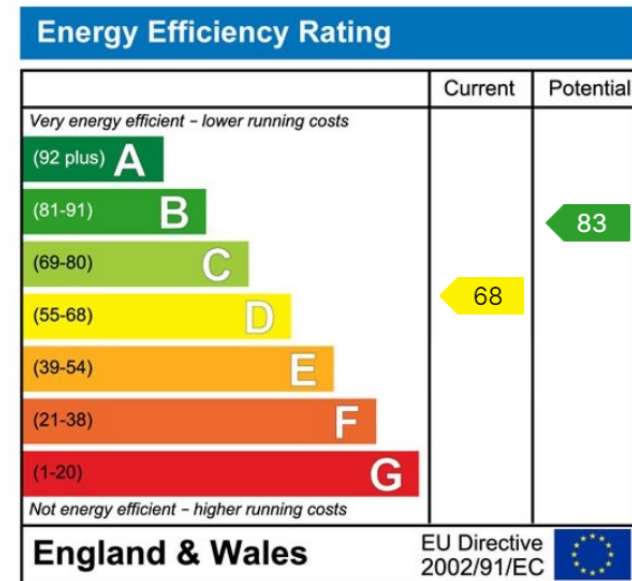
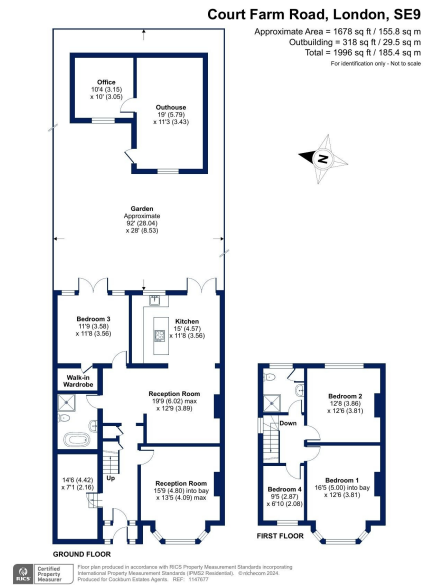

**Cockburn EA**  
 352 Footscray Road,  
 London, SE9 2EB  
 t: 020 8859 8590