



Andrew Pearce
PINNER

PINNER ROAD, PINNER, MIDDLESEX HA5 5RT



Offered for sale with no upper chain and situated in a sought after setting, within easy reach of shops, schools and transport links, is this three bedroom characterful terrace house ideal for the growing family.

The property briefly comprises an entrance hallway and a bright and spacious reception room. Completing the ground floor is a dining room following onto the fitted kitchen, enjoying eye and base level units, space for appliances, an under-stair pantry, and access to a guest cloakroom and a conservatory overlooking the garden.

To the first floor are three well-presented bedrooms and a shower room.

The garden enjoys fenced borders, a shed and patio, perfect for the summer months. To the front is a driveway providing off street parking for 2 cars.

Pinner Road is a short distance from Pinner and North Harrow High Streets with an array of shops, eateries and bus routes.

Their Metropolitan Line stations provide access into Central London. Within the local area are several highly regarded schools including St John Fisher Catholic Primary School, Pinner Park Infant, Nursery and Junior School and Nower Hill High School.

Freehold



GROUND FLOOR
525 sq.ft. (48.8 sq.m.) approx.

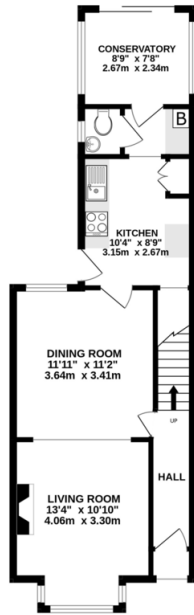

1ST FLOOR
435 sq.ft. (40.4 sq.m.) approx.

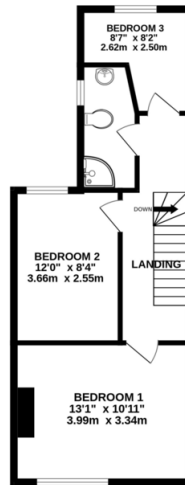

TOTAL FLOOR AREA: 960 sq.ft. (89.2 sq.m.) approx.

Whilst every attempt has been made to ensure the accuracy of the information contained herein, measurements of doors, windows, rooms and any other items are approximate and no responsibility is taken for any error, omission or mis-statement. This plan is for illustrative purposes only and should be used as such by any prospective purchaser. The services, systems and appliances shown have not been tested and no guarantee as to their operability or efficiency can be given.
Made with Metropix (2024)



