



218 HIGH STREET, SWANAGE
£325,000 Freehold

This attractive mid-terraced family house is situated in one of the oldest parts of Swanage, approximately one mile from the town centre and yet within easy reach of a local convenience store, schools and open country. It is thought to have been built during the latter part of the 19th Century and is constructed of Purbeck stone, the upper elevation being cement rendered with a pebbledash finish under a stone tiled roof (replaced in 2023) at the front and a slate roof at the rear.

218 High Street offers well presented, spacious accommodation with views across the town to the Purbeck Hills from the first floor. It also has the considerable advantage of an attractively landscaped enclosed rear garden.

The seaside town of Swanage is located at the Eastern tip of the Isle of Purbeck, delightfully situated between the Purbeck Hills. It has a safe, sandy beach and walkers and cyclists can enjoy the South West Coast Path as well as access to The Durlston Country Park. Swanage is some 10 miles from the market town of Wareham, which has main line rail links to London Waterloo (approx 2.5 hours). Much of the area surrounding the town is classified as being of Outstanding Natural Beauty incorporating the Jurassic Coast, which is part of the World Heritage Coastline.



The entrance hall leads to this recently modernised cottage. The living room is situated to the front of the property and has a feature fireplace with living flame electric fire. A wide throughway leads to the dining room, which overlooks the garden. The kitchen is fitted with a range of light units, contrasting worktops, integrated appliances and also has access to the rear garden.

On the first floor there are two double bedrooms, the principal bedroom is South facing and spans the width of the property. Bedroom two is also a good sized double and enjoys views of the Purbeck Hills. The stylish modern bathroom is fitted with both a panelled bath and a large walk-in shower and completes the accommodation. There is a loft space suitable for conversion, subject to consent.

Outside, there is a small garden to the front with flower border and shrubs. At the rear the fully enclosed garden is attractively landscaped with flowers, shrubs, bark chippings, ornamental tree, and timber deck creating an outdoor seating/dining area. There is also pedestrian access to a rear service lane.

All viewings are strictly by appointment through the Sole Agents, **Corbens, 01929 422284**. The postcode for this property is **BH19 2PQ**.

Property Ref **HIG2027**

Council Tax Band C - £2,274.51 for 2024/2025

Ground Floor

Total Floor Area
Approx. 84m² (904 sq ft)

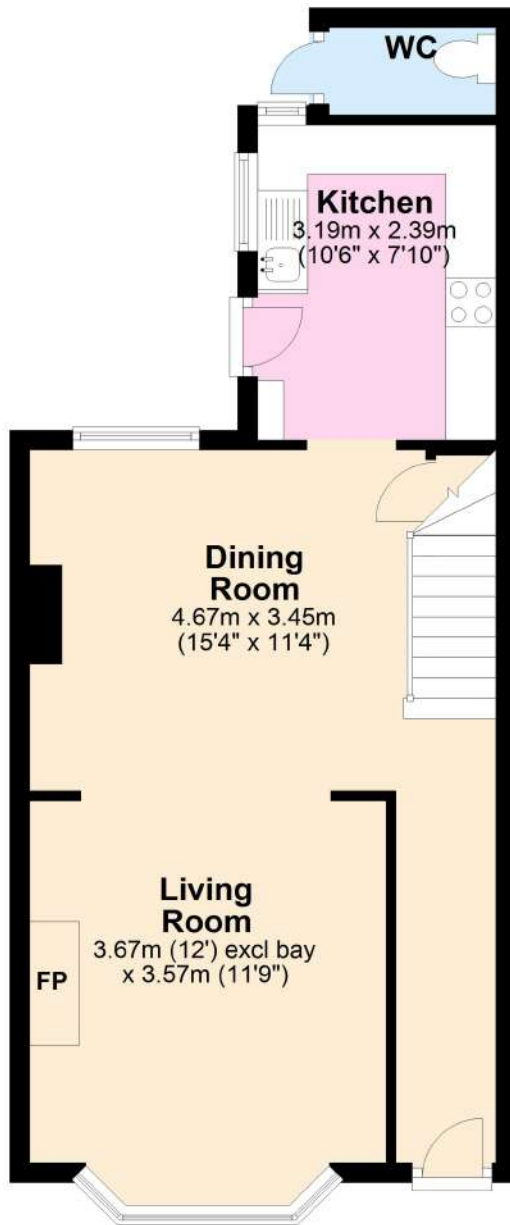

First Floor

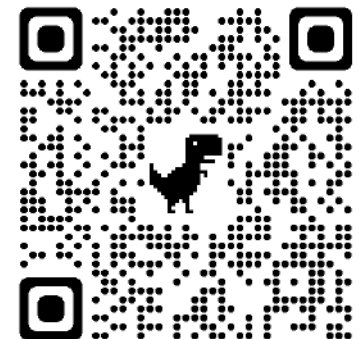
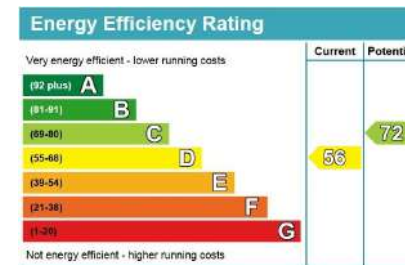

Scan to View Video Tour

THE PROPERTY MISDESCRIPTION ACT 1991 You are advised to check the availability of this property before travelling any distance to view. The Agent has not tested any apparatus, equipment, fixtures and fittings or services and so cannot verify that they are in working order or fit for the purpose. References to the Tenure of a Property are based on information supplied by the Seller. The area of the building is given for guidance purposes only and must be verified by the purchasers surveyor. A Buyer is advised to obtain verification of this information from their Solicitor and/or Surveyor. FLOOR PLANS The floor plans supplied are for guidance purposes only and should not be used for measuring. Small recesses, cupboards & sloping ceilings may not appear on the plans. LOCATION PLAN The location plans supplied are for identification purposes only and are reproduced from the Ordnance Survey Map with permission of the Controller of H.M. Stationery Office. Crown Copyright reserved.



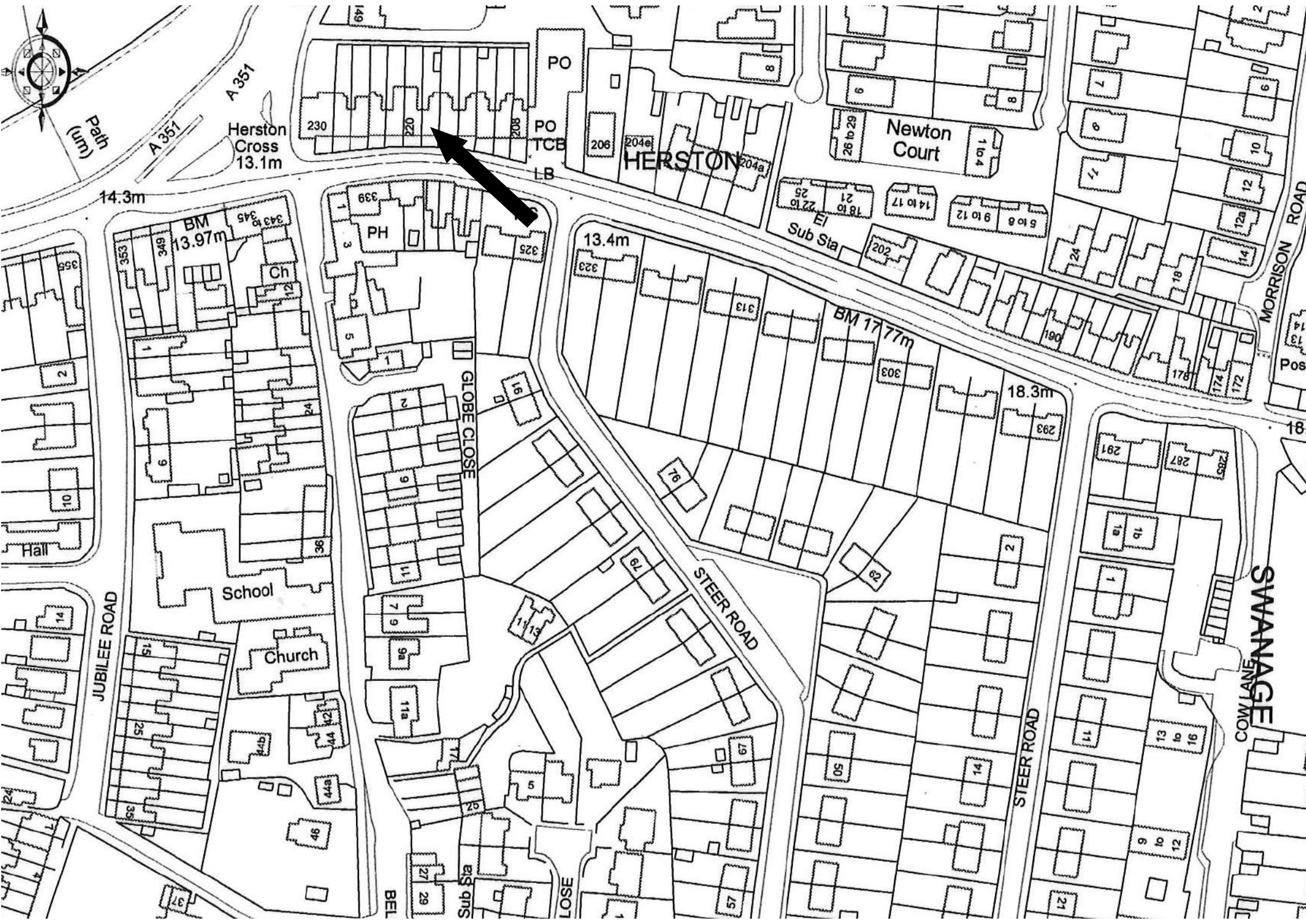

Path (um)
A 357
Herston Cross 13.1m
14.3m
BM 13.97m
Ch
Hall
School
Church
JUBILEE ROAD
PO
TCB
LB
HERSTON
Newton Court
Sub Sta
MORRISON ROAD
Post
SWANNAGE
COW LANE
STEER ROAD
GLOBE CLOSE
STEER ROAD
BEL
Sub gns
LOSE
230
022
802
206
204e
204a
26 to 29
1 to 4
5 to 8
9 to 12
14 to 17
18 to 21
22 to 25
202
293
18.3m
BM 17.77m
303
291
267
265
1b
1a
1
11
13
9
10
12
21
27
29
37
35
25
15
14
10
2
356
353
345
343
342
341
340
339
338
337
336
335
334
333
332
331
330
329
328
327
326
325
324
323
322
321
320
319
318
317
316
315
314
313
312
311
310
309
308
307
306
305
304
303
302
301
300
299
298
297
296
295
294
293
292
291
290
289
288
287
286
285
284
283
282
281
280
279
278
277
276
275
274
273
272
271
270
269
268
267
266
265
264
263
262
261
260
259
258
257
256
255
254
253
252
251
250
249
248
247
246
245
244
243
242
241
240
239
238
237
236
235
234
233
232
231
230
229
228
227
226
225
224
223
222
221
220
219
218
217
216
215
214
213
212
211
210
209
208
207
206
205
204
203
202
201
200
199
198
197
196
195
194
193
192
191
190
189
188
187
186
185
184
183
182
181
180
179
178
177
176
175
174
173
172
171
170
169
168
167
166
165
164
163
162
161
160
159
158
157
156
155
154
153
152
151
150
149
148
147
146
145
144
143
142
141
140
139
138
137
136
135
134
133
132
131
130
129
128
127
126
125
124
123
122
121
120
119
118
117
116
115
114
113
112
111
110
109
108
107
106
105
104
103
102
101
100
99
98
97
96
95
94
93
92
91
90
89
88
87
86
85
84
83
82
81
80
79
78
77
76
75
74
73
72
71
70
69
68
67
66
65
64
63
62
61
60
59
58
57
56
55
54
53
52
51
50
49
48
47
46
45
44
43
42
41
40
39
38
37
36
35
34
33
32
31
30
29
28
27
26
25
24
23
22
21
20
19
18
17
16
15
14
13
12
11
10
9
8
7
6
5
4
3
2
1

