



HILL VIEW, COOMBE HILL, LANGTON MATRAVERS
£395,000

This semi-detached cottage is thought to have been built during the 1800s and is of solid stone construction with partially cement rendered external elevations, under a pitched roof covered stone tiles.

Whilst in need of updating throughout, Hill View offers good sized family accommodation, with the benefit of views of the Purbeck Hills at the front and farmland at the rear.

Langton Matravers lies at the heart of the Isle of Purbeck and sits to the West of the seaside resort of Swanage (2.5 miles distant) with its fine, sandy beach and the market town of Wareham (some 9 miles distance), the latter having main line rail link to London Waterloo (approximately 2.5 hours). Much of the area surrounding the village is classified as being of Outstanding Natural Beauty incorporating the Jurassic Coast, part of the World Heritage Coastline.

Property Ref LAN1919

Council Tax Band D - £2589.01 for 2025/2026



The entrance leads directly to the large open plan living/dining room with flagstone flooring. The living area has an open fireplace and the dining area has exposed stone walls and a door to the rear garden. The kitchen is in need of replacement but has a pleasant dual aspect. The single bedroom with en-suite shower room completes the ground floor accommodation.

On the first floor, there are two bedrooms; bedroom one is particularly spacious and benefits from fitted wardrobes and both bedrooms have views across the valley to the Purbeck Hills. The family bathroom is at the rear of the property and has views over adjacent farmland.

Outside, the split-level rear garden is mostly laid to grass with shrubs and trees. There is also access to an outside timber store.

VIEWING By appointment only through Corbens, 01929 422284. The postcode for this property is **BH19 3EU**.

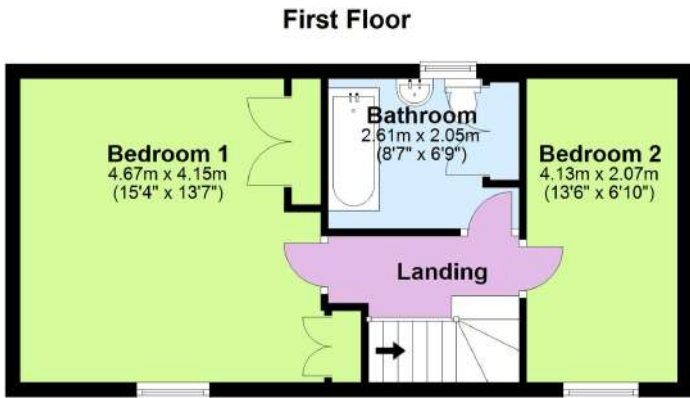
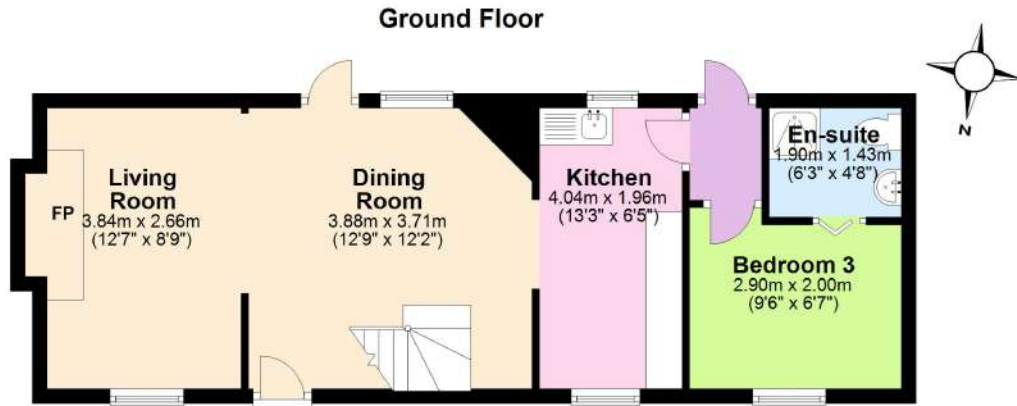

Total Floor Area Approx. 93m² (1,001sq ft)



Energy Efficiency Rating			
Very energy efficient - lower running costs		Current	Potential
(92 plus)	A		
(81-91)	B		
(69-80)	C		77
(55-68)	D		
(39-54)	E		
(21-38)	F	44	
(1-37)	G		
Not energy efficient - higher running costs			

