



Lansdowne Place, SE19 | £475,000

020 8702 9333

[crystalpalace@pedderproperty.com](mailto:crystalpalace@pedderproperty.com)

**pedder**  
We live local





# In General

- 1045 sq ft / 97.2 sq m
- Two bedroom split level apartment
- Central location
- Secure gated development
- No onward chain
- 21ft reception room

# In Detail

A particularly spacious two bedroom split level apartment centrally located in the heart of Crystal Palace and available for sale with no onward chain.

This light and bright property boasts 1045 sq ft / 97.2 sq m and is a neutrally decorated blank canvas for a new owner to put their stamp on. The reception room extends to 21ft and is socially open to a kitchen with a sit-up breakfast bar and has dual aspect sash windows. This makes for an excellent entertaining and relaxing space. The lower level houses the bedrooms and a particularly spacious four piece bathroom.

This secure gated development is quietly tucked away, although enables immediate access to the various bars, restaurants and leisure options of the Triangle. Also, convenient for both Gipsy Hill and Crystal Palace rail links, as well as Crystal Palace Park.

EPC: B | Council Tax Band: C | Lease: 105 Years remaining | SC: £2,200pa | GR: £250pa | BI: TBC



# Floorplan

**15 Lansdowne Place**  
Total\* = 97.2 sq m / 1045.8 sq ft  
First Floor = 49.9 sq m / 537.5 sq ft  
Upper Ground Floor = 47.2 sq m / 508.3 sq ft  
☐ = Reduced head room below 1.5m

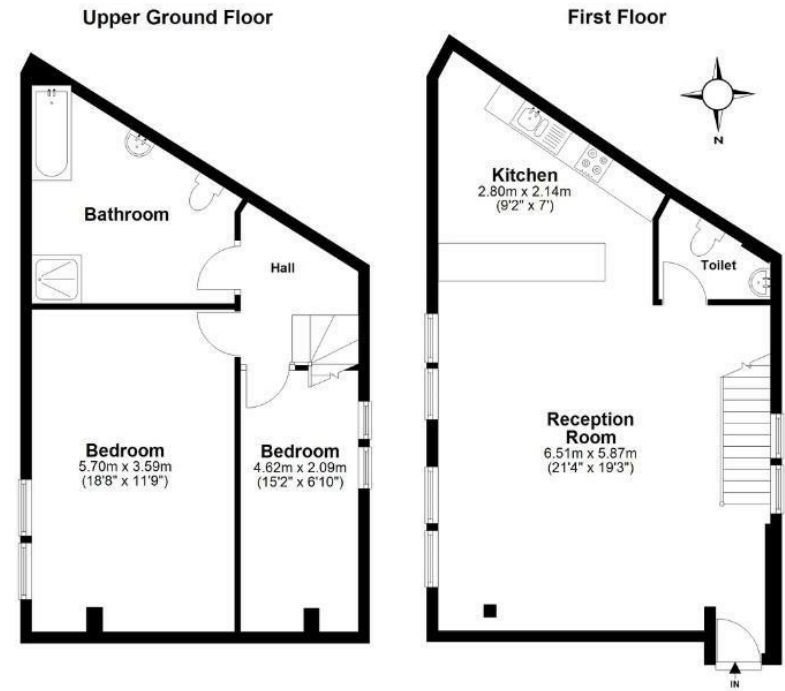

\*All measurements are approximate and do not include eaves space. The plans are for representation purposes only as defined by RICS - 'Code of Measurement Practice'. The plans are not to scale. Please personally check all sizes, dimensions, shapes and compass bearings before making any decisions reliant upon them. Copyright The Pedder Group © 2026.

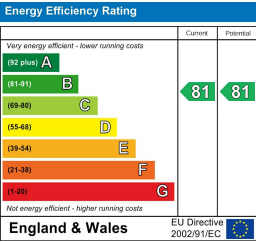

Pedder Property Ltd trading as Pedder for themselves and for the vendor/landlord of this property whose agents they are, give notice that (1) these particulars do not constitute any part of an offer or contract, (2) all statements contained within these particulars are made without responsibility on the part of Pedder or the vendor/landlord, (3) whilst made in good faith, none of the statements contained within these particulars are to be relied upon as a statement of representation or fact, (4) any intending purchaser/tenant must satisfy him/herself by inspection or otherwise as to the correctness of each of the statements contained within these particulars, (5) the vendor/landlord does not make or give either Pedder or any person in their employment any authority to make or give representation or warranty whatsoever in relation to this property.