



Sheringham Road, SE20 | Guide Price £550,000

020 8702 9333

crystalpalace@pedderproperty.com

pedder
We live local



In General

- Three bedroom house
- Quiet residential road
- Nearby multiple transport links
- Close to Stewart Fleming primary school
- Generous rear garden
- Scope of remodel / extension (STP)

In Detail

**** Guide Price £550,000 - £575,000 **** This charming 1930s three bedroom family home is set on a quiet residential road, conveniently located for excellent transport links and a wide range of local amenities.

Full of character, the property features stripped wood flooring throughout and two bright reception rooms, with scope (STP) to open up the kitchen or create a rear extension. Upstairs there are three neatly arranged bedrooms and a family bathroom. The rear garden extends to approximately 65ft and enjoys an easterly aspect, with a patio area ideal for outdoor dining and relaxation.

These solidly built homes are particularly popular for the versatility they offer, providing numerous opportunities to extend or remodel (STP) to suit individual needs.

Sheringham Road is close to a selection of shops, supermarkets and independent businesses that serve the local community, and the highly regarded Stewart Fleming Primary School is just moments away. Birkbeck, Kent House, Elmers End and Anerley stations are all within easy walking distance, offering excellent direct services to London Bridge, Victoria, Charing Cross, Canada Water, Shoreditch and many other destinations across London and beyond.

EPC: C | Council Tax Band: D



Floorplan

Sheringham Road, SE25

Approximate Gross Internal Area
81.9 sq m / 881 sq ft

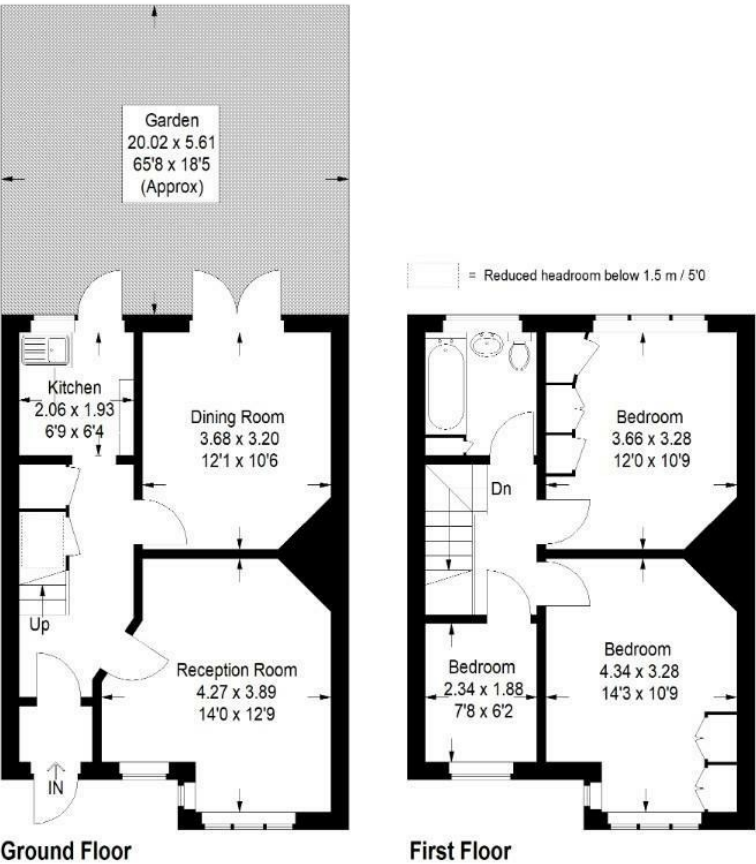

Copyright www.pedderproperty.com © 2025
These plans are for representation purposes only as defined by RICS - Code of Measuring Practice. Not drawn to Scale.
Windows and door openings are approximate. Please check all dimensions, shapes and compass bearings before making any decisions reliant upon them.

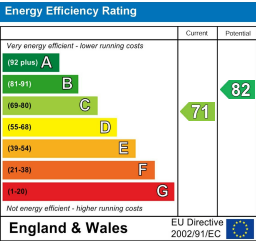

Pedder Property Ltd trading as Pedder for themselves and for the vendor/landlord of this property whose agents they are, give notice that (1) these particulars do not constitute any part of an offer or contract, (2) all statements contained within these particulars are made without responsibility on the part of Pedder or the vendor/landlord, (3) whilst made in good faith, none of the statements contained within these particulars are to be relied upon as a statement of representation or fact, (4) any intending purchaser/tenant must satisfy him/herself by inspection or otherwise as to the correctness of each of the statements contained within these particulars, (5) the vendor/landlord does not make or give either Pedder or any person in their employment any authority to make or give representation or warranty whatsoever in relation to this property.