



Queen Mary Road, SE19 | Offers Over £300,000

02087029333
crystalpalace@pedderproperty.com





In General

- Ground floor conversion
- One bedroom
- Fully refurbished
- Decked rear garden
- Office/studio
- Naturally bright
- No onward chain
- Quiet road

In Detail

A fully refurbished one bedroom ground floor period conversion with a private garden, available for sale with no onward chain.

The accommodation has been finished to a good standard throughout and comprises of a new kitchen which includes a dishwasher, a new spacious shower-room, a recently decked split-level garden which has a separate office/studio, a double bedroom and reception room to the front. Complete with newly laid flooring, repainted throughout, and double glazed windows.

Queen Mary Road is a quiet community-orientated location. The area is primarily served by West Norwood rail links but bus routes at the end of the road also connect to Brixton, Gipsy Hill and Crystal Palace. Shopping facilities can be found at nearby Crown Point.

EPC: C | Council Tax Band: B | Lease: TBC | SC: £795.46 | GR: Peppercorn | BI: Incl in SC

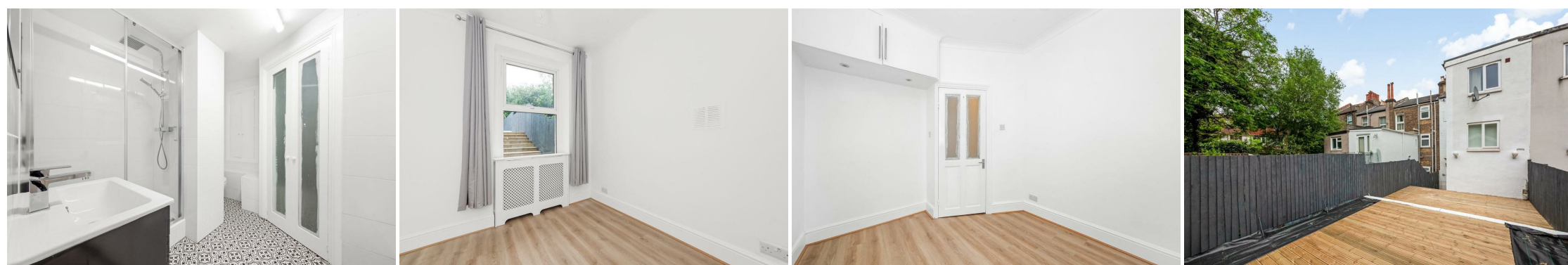

Floorplan

Queen Mary Road, SE19

Approximate Gross Internal Area
(Excluding Outbuilding)
42.8 sq m / 461 sq ft

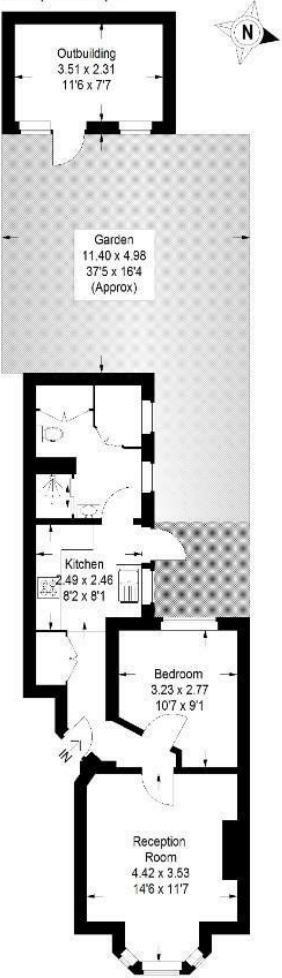

Ground Floor

Copyright www.pedderproperty.com © 2024
These plans are for representation purposes only as defined by RICS - Code of Measuring Practice. Not drawn to Scale. Windows and door openings are approximate. Please check all dimensions, shapes and compass bearings before making any decisions reliant upon them.

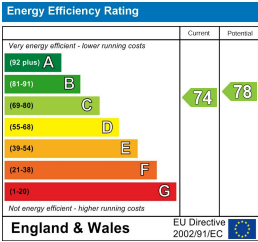

Pedder Property Ltd trading as Pedder for themselves and for the vendor/landlord of this property whose agents they are, give notice that (1) these particulars do not constitute any part of an offer or contract, (2) all statements contained within these particulars are made without responsibility on the part of Pedder or the vendor/landlord, (3) whilst made in good faith, none of the statements contained within these particulars are to be relied upon as a statement of representation or fact, (4) any intending purchaser/tenant must satisfy him/herself by inspection or otherwise as to the correctness of each of the statements contained within these particulars, (5) the vendor/landlord does not make or give either Pedder or any person in their employment any authority to make or give representation or warranty whatsoever in relation to this property.