



Anerley Park, SE20 8NG

£390,000

02087029333

[crystalpalace@pedderproperty.com](mailto:crystalpalace@pedderproperty.com)

**pedder**  
We live local



## In General

- Three bedrooms
- Separate kitchen
- 927 sq ft / 86.1 sq m
- Highly regarded location
- Basement storage room
- Nearby multiple transport links
- Covered balcony
- Well maintained communal grounds

## In Detail

A spacious three bedroom second floor purpose built apartment on a highly regarded road moments from Crystal Palace Park.

This property boasts 927 sq ft / 86.1 sq m and is quietly set back from the road within this private low-rise development. There are three well proportioned bedrooms (two with plenty of fitted storage) and a separate kitchen which enough work space for those who enjoy cooking. Also, a 16ft 9 reception room which has direct access to a covered balcony overlooking manicured communal grounds. Further benefits include a separate WC, a basement storage room (ideal for bikes), residents off street parking, and an exceptionally long lease.

Anerley Park works well for access to Crystal Palace, Anerley and both Penge East / West rail links. Nearby leisure and shopping amenities include central Crystal Palace, Anerley Parade and the High Street, whilst also just a short walk to 200 acres of parkland.

EPC: C | Council Tax Band: C | Lease: 176 years remaining | SC: £125pm | GR: £0 | BI: Included in service charge

EPC: | Council Tax Band: C



# Floorplan

**Park House, SE20**  
**Approximate Gross Internal Area**  
**86.1 sq m / 927 sq ft**

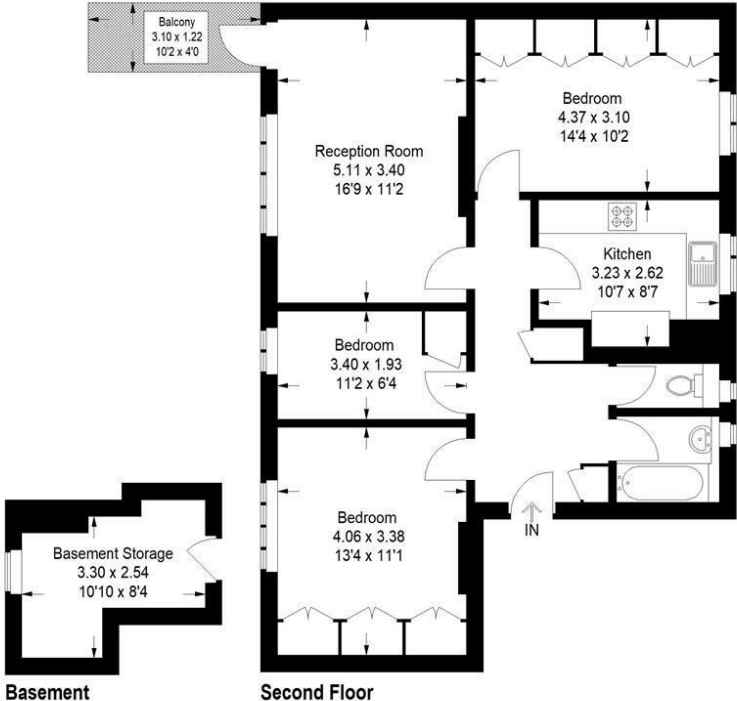

Copyright www.pedderproperty.com © 2024  
 These plans are for representation purposes only as defined by RICS - Code of Measuring Practice.  
 Not drawn to Scale. Windows and door openings are approximate. Please check all dimensions, shapes and compass bearings before making any decisions reliant upon them.

Energy Efficiency Rating		Current	Potential
Very energy efficient - lower running costs			
(92 plus) <b>A</b>			
(81-91) <b>B</b>			
(69-80) <b>C</b>			
(55-68) <b>D</b>			
(39-54) <b>E</b>			
(21-38) <b>F</b>			
(1-20) <b>G</b>			
Not energy efficient - higher running costs			
<b>England &amp; Wales</b>	EU Directive 2002/91/EC		

Pedder Property Ltd trading as Pedder for themselves and for the vendor/landlord of this property whose agents they are, give notice that (1) these particulars do not constitute any part of an offer or contract, (2) all statements contained within these particulars are made without responsibility on the part of Pedder or the vendor/landlord, (3) whilst made in good faith, none of the statements contained within these particulars are to be relied upon as a statement of representation or fact, (4) any intending purchaser/tenant must satisfy him/herself by inspection or otherwise as to the correctness of each of the statements contained within these particulars, (5) the vendor/landlord does not make or give either Pedder or any person in their employment any authority to make or give representation or warranty whatsoever in relation to this property.