

Northfield Avenue, London, W13

Approximate Floor Area = 43.0 sq m / 463 sq ft

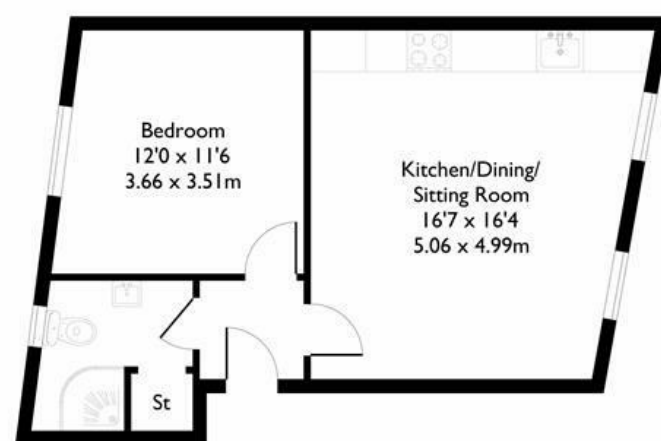

First Floor

Floor plan produced in accordance with RICS Property Measurement 2nd Edition. Although Pink Plan Ltd ensures the highest level of accuracy, measurements of doors, windows and rooms are approximate and no responsibility is taken for error, omission or misstatement. These plans are for representation purposes only and no guarantee is given on the total square footage of the property within this plan. The figure icon is for initial guidance only and should not be relied on as a basis of valuation.



## FLAT

# Northfield Avenue W13 £1,700 PCM

## FEATURES

- New Build
- One Bedroom
- Open Plan Living
- Short Walk To Transport
- Engineered Oak Flooring Throughout
- AEG Appliances



FLAT

# Northfield Avenue W13

£1,700 PCM

Nestled in the vibrant heart of Northfield Avenue, Ealing, this exquisite new build flat presents an exciting opportunity for those seeking a modern living space. Set to be completed in August 2025, this property offers the unique advantage of being the first occupant, allowing you to enjoy a fresh and pristine environment.

Spanning an impressive 490 square feet, this flat features a well-designed layout that includes a comfortable reception room, a spacious bedroom, and a stylish bathroom. The combination of luxury and convenience is evident throughout, making it an ideal choice for professionals or

