

Broughton Court, Broughton Road, London, W13
Approximate Floor Area = 62.0 sq m / 668 sq ft

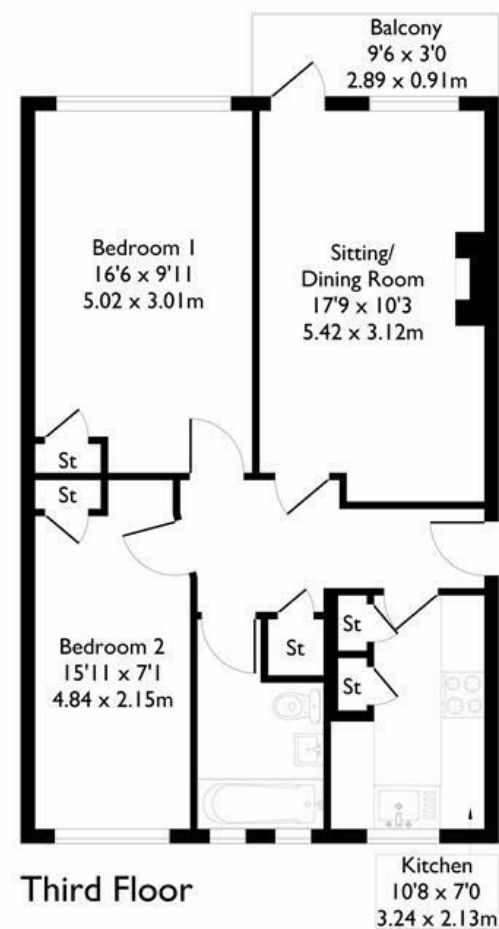

Floor plan produced in accordance with RICS Property Measurement 2nd Edition. Although Pink Plan Ltd ensures the highest level of accuracy, measurements of doors, windows and rooms are approximate and no responsibility is taken for error, omission or misstatement. These plans are for representation purposes only and no guarantee is given on the total square footage of the property within this plan. The figure icon is for initial guidance only and should not be relied on as a basis of valuation.



FLAT

Broughton Road W13 £1,875 PCM

FEATURES

- 2 Double Bedrooms
- Close to amenities
- Walking distance to West Ealing Station
- Elizabeth Line
- Private Balcony
- Communal Garden

FLAT

Broughton Road W13

£1,875 PCM

Situated on Broughton Road, this delightful property offers a perfect blend of comfort and convenience. Spanning 667 square feet, this flat features two well-proportioned bedrooms, making it an ideal choice for small families, couples, or individuals seeking extra space. Another standout features of the property is the private balcony, in addition, residents have access to a well-maintained communal garden

Located in a vibrant and well-connected neighbourhood, the property benefits from excellent transport links, making commuting simple and efficient. A wide array of local amenities, including shops, cafés, parks, and recreational facilities, are all just a short walk away, ensuring everything you need is close at hand.

