

Coningsby Road, London, W5
Approximate Floor Area = 53.8 sq m / 580 sq ft

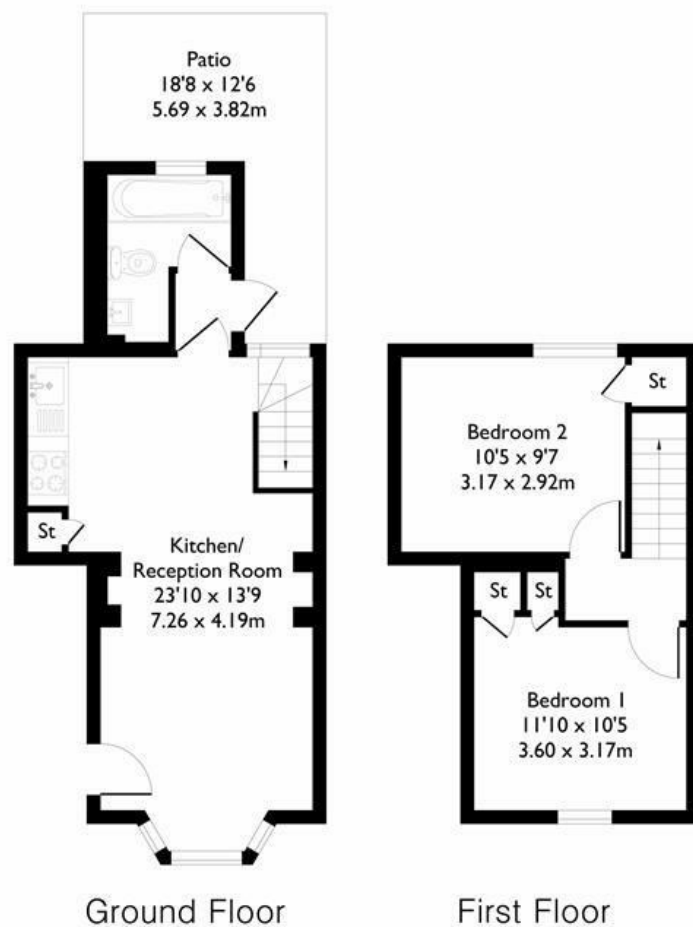

Floor plan produced in accordance with RICS Property Measurement 2nd Edition. Although Pink Plan Ltd ensures the highest level of accuracy, measurements of doors, windows and rooms are approximate and no responsibility is taken for error, omission or misstatement. These plans are for representation purposes only and no guarantee is given on the total square footage of the property within this plan. The figure icon is for initial guidance only and should not be relied on as a basis of valuation.



FLAT

Coningsby Road W5 £2,000 PCM

FEATURES

- Private Garden
- Ground Floor
- Split Level
- Double Rooms
- Minutes From Station
- Close To Amenities

FLAT

Coningsby Road W5

£2,000 PCM

This beautifully presented two bedroom split level garden property is located on a beautiful residential road just moments from South Ealing tube station. The property itself is bright and open throughout with the ground floor comprising a living room, kitchen with dining area, large bathroom and access on to the well maintained garden. The first floor has two excellent size double bedrooms, both of which have built in storage.

