

Chiswick Terrace, W4 5LY

Approximate Gross Internal Area
986 sq ft / 91.60 sq m

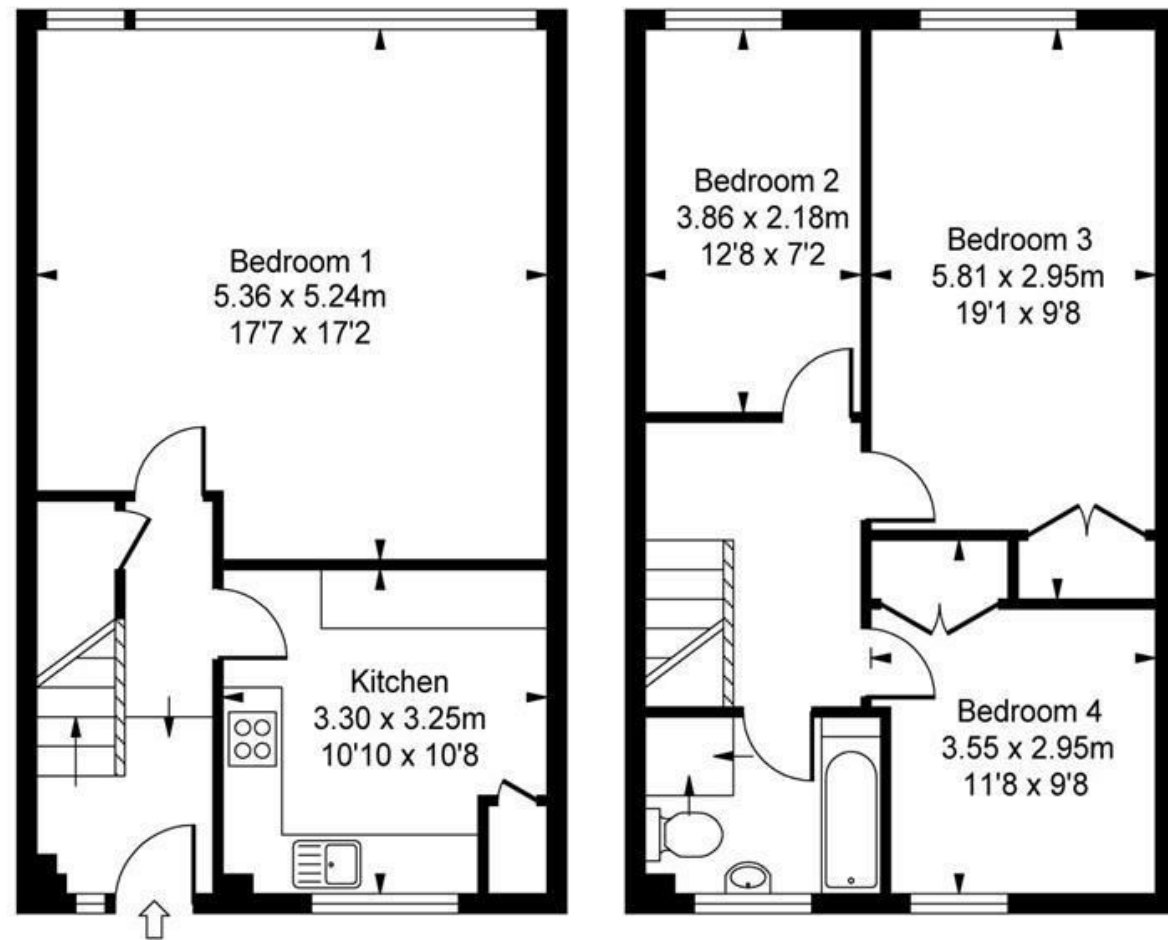

ILLUSTRATION FOR IDENTIFICATION PURPOSES ONLY
ALL MEASUREMENTS ARE MAXIMUM, AND INCLUDE WINDOW BAYS AND WARDROBES WHERE APPLICABLE
THIS PLAN MUST NOT BE REPRODUCED BY ANY OTHER PERSON WITHOUT PERMISSION



NOT SPECIFIED

FEATURES

Chiswick Terrace W4
£800 Per Month

NOT SPECIFIED

Chiswick Terrace W4

£800 Per Month

Room to rent
Double room in a shared terraced maisonette and includes all bills. The room is within a 5 minute walk away from Chiswick Park Tube Station (district line) with its multiple transport links in and out of the city and is also within easy walking distance of Chiswick High Road's shops, bars and restaurants. Please note that there is no communal living area in this accommodation. Shared use of bathroom and kitchen.

