



Lemna Road, E11

£299,950

Introducing The Penthouse Collection at Robart House. This one-bedroom apartment boasts a large open-plan living room, benefiting from stunning panoramic views of the London skyline. The specification includes engineered oak flooring, Bosch appliances in the kitchen, and marble tiling in the bathroom.

Just a short walk from the Underground Station, Leytonstone offers great connectivity with the Central line. Oxford Circus, Bank, and Liverpool Street are easily accessible. Well-serviced bus routes also connect the surrounding areas. Leytonstone High street offers eclectic mix of cafes, restaurants, and boutiques as well as nearby parks and green spaces.

Features

- One Bedroom
- Panoramic City Views
- 10 Year Warranty
- 15 Minutes To Liverpool Street

Lemna Road,
London, E11

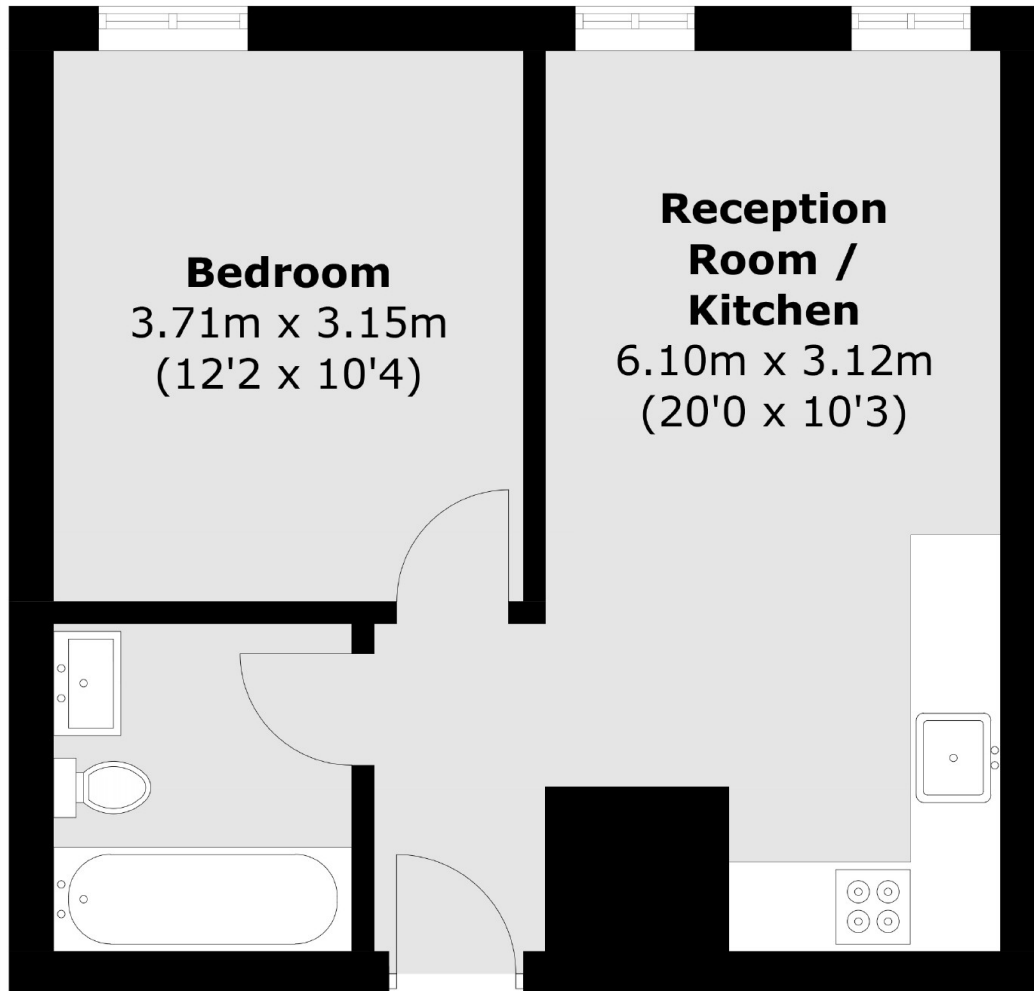

Total area (approx.): 38.5 sq. m 414.4 sq. ft)

Dexters

New Homes North & East
76 Upper Street
London
N1 0NU

020 7590 7299

Energy Rating: . We aim to make our particulars both accurate and reliable. However they are not guaranteed; nor do they form part of an offer or contract. If you require clarification on any points then please contact us, especially if you're traveling some distance to view. Please note that appliances and heating systems have not been tested and therefore no warranties can be given as to their good working order.

 **RICS** | Regulated
Estate Agent
and Letting Agent

dexters.co.uk