



Manorgate Road, KT2

£450,000

Last Apartment Remaining & Ready To Move In! - Apartment 6 is a beautiful one bedroom apartment on the ground floor at Baring House. The apartment boast high ceilings whilst offering private outside space. Every aspect of this unique development has been carefully designed to offer an unrivalled standard of living. Another added benefit to the apartment is a private parking space outside the development.

Baring House is located in Kingston upon Thames and conveniently situated for the mainline station and the town centre. The development provides convenient access to the third biggest shopping destination in London and a train link to London Waterloo. Hampton Court Palace, Bushy Park, Esher College, Kingston University and top ranked schools are all located near Baring House.

Baring House is superbly positioned for a variety of transport options; access to the A3 and the M25. Heathrow and Gatwick Airports are both easily accessible by road, respectively.

Features

Ready To Move In
Close To Norbiton Station
Close To Kingston Town Centre
High Specification
Private Outdoor space
Close To Richmond Park
Parking Space

Manorgate Road,
Kingston Upon Thames, KT2

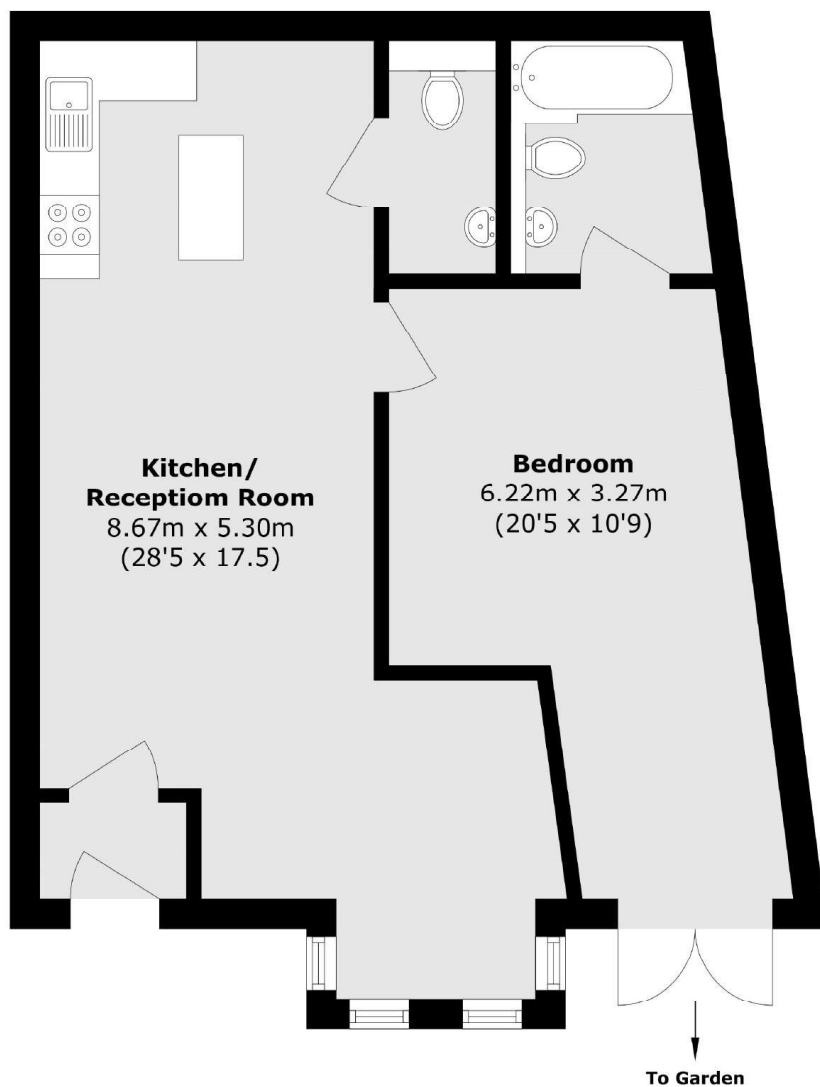

Total area (approx.): 63.1 sq. m (679.2 sq. ft)