

# Towers Wills

Town & Country

📞 01935 577 032 | 01460 298 530 | ✉ info@towerswills.co.uk



98, Mudford Road, Yeovil, Somerset BA21 4AJ

**£460,000**

Towers Wills are delighted to market this beautifully presented four-bedroom detached period home, believed to date from the 1930s, situated in one of Yeovil's most sought-after residential locations.

### **Accommodation:**

Under the current ownership, this impressive 1930's property has been thoughtfully extended and significantly improved to provide generous and versatile living accommodation, ideally suited to modern family life. The well-balanced layout offers both spacious reception areas, downstairs wc and excellent bedroom proportions, with the principal bedroom enjoying the added benefits of a stylish ensuite and a useful dressing area and a main bathroom with a corner bath.

### **Outside:**

To the rear, the property boasts a delightful garden featuring a raised decked seating area, an additional patio for outdoor entertaining, and the remainder laid to lawn. The garden is further enhanced by a pond and a summer house positioned in the far corner, creating an attractive and private outdoor retreat. There is also a cabin approx. 14x12.

To the front, the property provides ample driveway parking for several vehicles. The home occupies a highly desirable position within Mudford Road, offering convenient access to local amenities while remaining within a well-established and popular part of Yeovil.

An outstanding opportunity to acquire a substantial and extended detached family home in a prime residential setting.

## **Key Features**

- Detached House
- Sought-after Location
- Four Bedrooms
- Master En-suite
- Well Presented Throughout
- Driveway Parking
- Double Garage

## **Contact Us**

### **Towers Wills Estate Agents - Yeovil**

114, Hendford Hill  
Yeovil

Somerset  
BA202RF

T: 01935 577032

E: [info@towerswills.co.uk](mailto:info@towerswills.co.uk)





# Floor Plan

GROUND FLOOR

1ST FLOOR

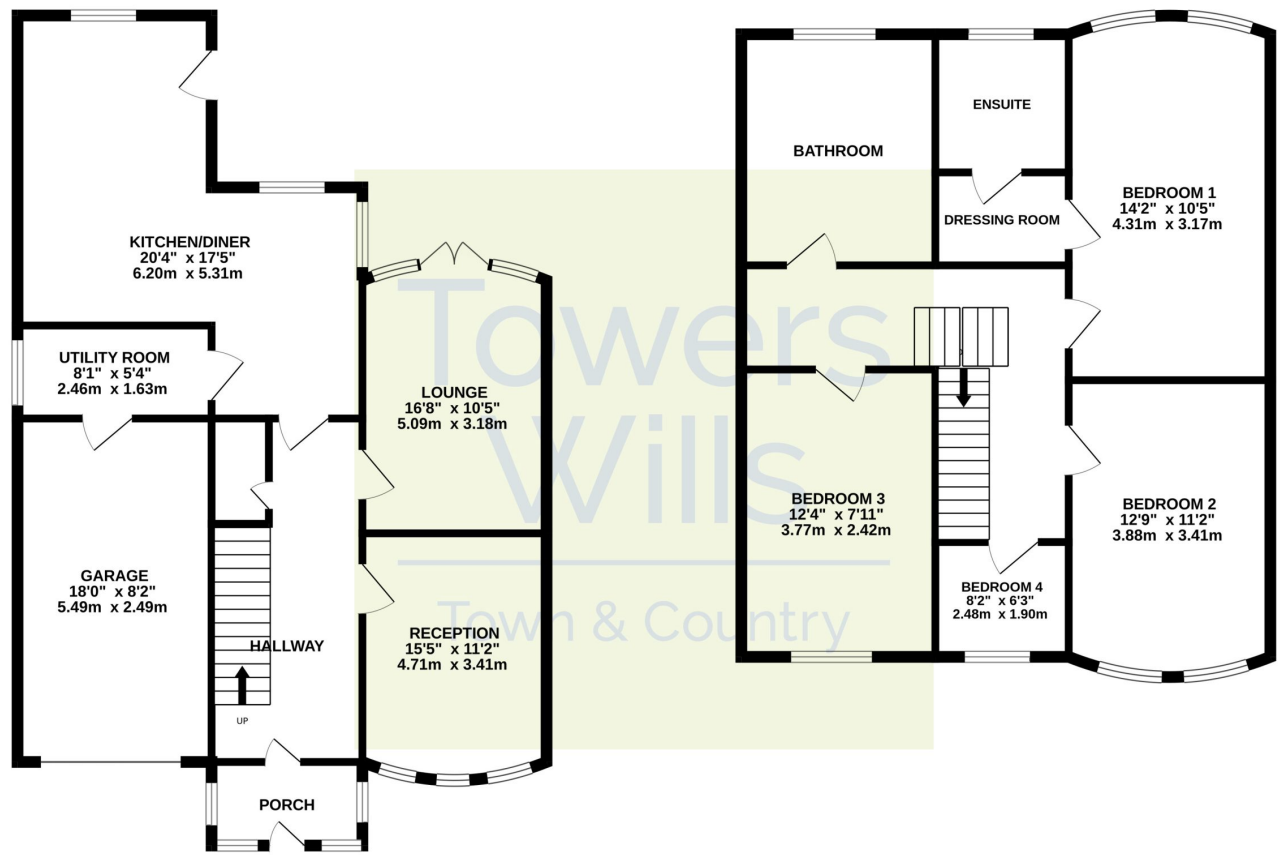

Whilst every attempt has been made to ensure the accuracy of the floorplan contained here, measurements of doors, windows, rooms and any other items are approximate and no responsibility is taken for any error, omission or mis-statement. This plan is for illustrative purposes only and should be used as such by any prospective purchaser. The services, systems and appliances shown have not been tested and no guarantee as to their operability or efficiency can be given.  
Made with Metropix ©2025

Please Note No tests have been undertaken of any of the services and any intending purchasers should satisfy themselves in this regard. Towers Wills Ltd for themselves and for the vendor of this property whose agents they are, give notice that, (i) these particulars do not constitute any part of an offer or contract, (ii) all statements contained within these particulars are made without responsibility on the part of Towers Wills or the vendor, (iii) whilst made in good faith, none of the statements contained within these particulars are to be relied upon as a statement of representation or fact, (iv) any intending purchaser must satisfy him/herself by inspection or otherwise as to the correctness of each of the statements contained within these particulars, (v) the vendor does not make or give either Towers Wills or any person in their employment any authority to make or give representation or warranty whatsoever in relation to this property.

Photographs / Floor Plans Photographs are reproduced for general information and it must not be inferred that any item is included for sale with this property. Please note floor plans are not to scale and are for identification purposes only. The photographs used in these particulars may have been taken with the use of a wide angle lens. If you have any queries as to the size of the accommodation or plot, please address these with the agent prior to making an appointment to view

**Towers Wills**

The White House, 114 Hendford Hill, Yeovil BA20 2RF

Yeovil 01935 577032 / South Petherton 01460 298530

[info@towerswills.co.uk](mailto:info@towerswills.co.uk) | [www.towerswills.co.uk](http://www.towerswills.co.uk)