

Towers Wills

Town & Country

📞 01935 577 032 | 01460 298 530 | ✉ info@towerswills.co.uk



31, Tristram Close, Yeovil, Somerset BA21 3GU

£220,000

Towers Wills welcome to the market this well presented town house. The property benefits from a downstairs cloakroom, lounge/diner and kitchen while on the first floor there are two bedrooms and family bathroom with the master bedroom plus en-suite on the second floor. The property has off-road parking for two vehicles (including one within a carport). Sunny South / West aspect rear garden. Pleasant outlook onto a small area of Woodland to the front.

Hallway

Double glazed door to the front and radiator.

Cloak W.C

Includes radiator, wash hand basin, w.c and extractor fan.

Kitchen

Comprising of a range of wall, base and drawer units, work surfacing with inset sink/drain, radiator, double glazed window to the front, integrated gas hob, integrated electric oven, cookerhood over, space for washing machine, space for fridge freezer and central heating boiler.

Living room

Radiator and double glazed French doors to the rear garden.

First floor landing

Radiator and double glazed window to the front.

Bedroom Two

Radiator, double glazed window to the rear and two built-in wardrobes.

Bedroom Three

Double glazed window to the front and radiator.

Bathroom

Suite comprising bath with shower over, wash hand basin, w.c, radiator and extractor fan.

Second floor landing

Cupboard.

Bedroom One 4.22m x 2.86m - maximum measurements (restricted head height)

Two double glazed skylights to the rear, radiator and built-in airing cupboard/wardrobe with integrated heating water system.

En-Suite

Suite comprising shower cubicle, wash hand basin, w.c, radiator, double glazed window to the front, shaver point and extractor fan.

Front Garden

To the front there is a gravel area.

Rear Garden

To the rear the garden is a patio area, artificial area lawned area with a gate leading to the parking.

Parking

There are two parking spaces in tandem (one with a carport).

Key Features

- Three double bedrooms
- En-suite
- Car port & driveway
- West facing garden
- Townhouse
- Well presented throughout
- Cloak W.C

Contact Us

Towers Wills Estate Agents - Yeovil

114, Hendford Hill
Yeovil

Somerset
BA202RF

T: 01935 577032

E: info@towerswills.co.uk



Floor Plan

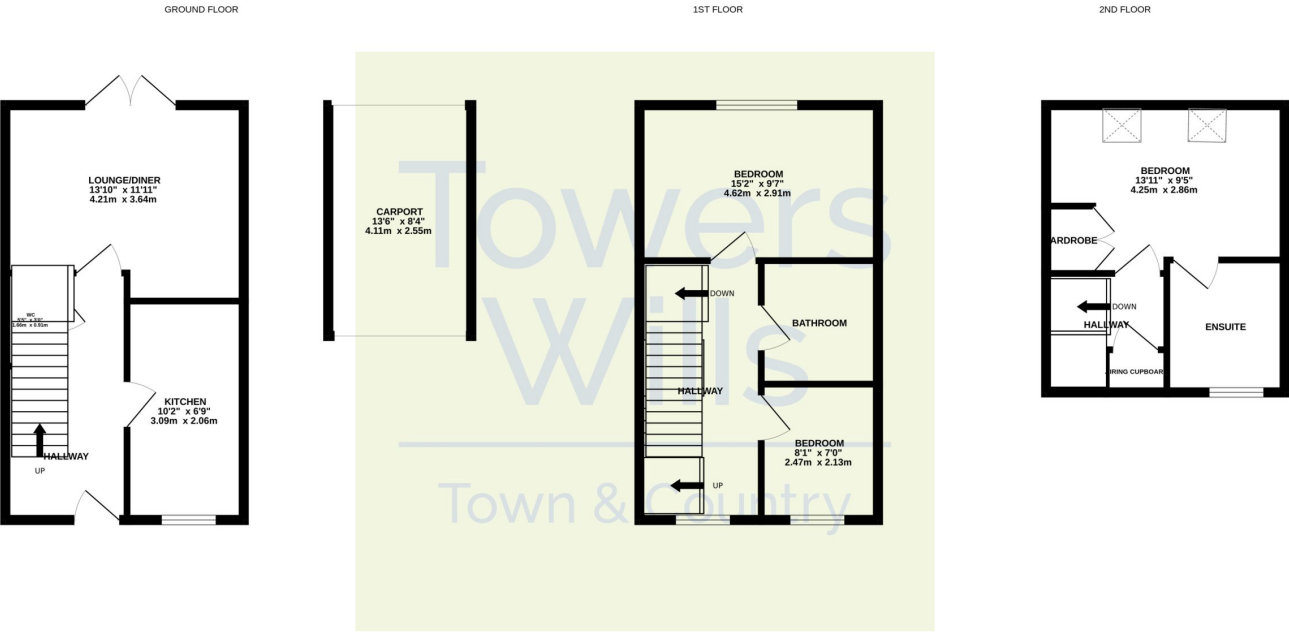

Whilst every attempt has been made to ensure the accuracy of the floorplan contained here, measurements of doors, windows, rooms and any other items are approximate and no responsibility is taken for any error, omission or mis-statement. This plan is for illustrative purposes only and should be used as such by any prospective purchaser. The services, systems and appliances shown have not been tested and no guarantee as to their operability or efficiency can be given.
Made with Metropix ©2025

Please Note No tests have been undertaken of any of the services and any intending purchasers should satisfy themselves in this regard. Towers Wills Ltd for themselves and for the vendor of this property whose agents they are, give notice that, (i) these particulars do not constitute any part of an offer or contract, (ii) all statements contained within these particulars are made without responsibility on the part of Towers Wills or the vendor , (iii) whilst made in good faith, none of the statements contained within these particulars are to be relied upon as a statement of representation or fact , (iv) any intending purchaser must satisfy him/herself by inspection or otherwise as to the correctness of each of the statements contained within these particulars, (v) the vendor does not make or give either Towers Wills or any person in their employment any authority to make or give representation or warranty whatsoever in relation to this property.

Photographs / Floor Plans Photographs are reproduced for general information and it must not be inferred that any item is included for sale with this property. Please note floor plans are not to scale and are for identification purposes only. The photographs used in these particulars may have been taken with the use of a wide angle lens. If you have any queries as to the size of the accommodation or plot, please address these with the agent prior to making an appointment to view