

Towers Wills

Town & Country

📞 01935 577 032 | 01460 298 530 | ✉ info@towerswills.co.uk



11, Crane Road, Yeovil, Somerset BA22 8FW

Offers Over **£200,000**

Towers Wills welcome to the market this immaculate Detached Coach House in a popular location. Briefly comprising entrance hall with stairs leading to the first floor. An open plan kitchen/lounge/dining room, two bedrooms, bathroom, double garage and parking space.

Entrance Hall

Ground floor entrance leading into the entrance hall with stairs to first floor landing.

First floor

A welcoming entrance hall with window outlook to the rear and cupboard.

Kitchen/Diner/Lounge 5.43m x 5.75m

A modern kitchen fitted with timber effect worktop, cream doors with a range of wall and base units. A stainless steel sink drainer unit with mixer tap, a four-ring gas hob with oven under and extractor hood over. Plumbing for washing machine, space for dishwasher, radiator and recess lighting. A dual aspect room with outlook to the front and rear, tv point and further radiator.

Bedroom One 4.36m x 2.70m

With window outlook to the rear and radiator.

Bedroom Two 2.97m x 4.13m

With window outlook to the front, fitted wardrobes and radiator.

Bathroom 1.78m x 2.21m

A modern white suite fitted with panel bath, mixer tap and side screen. WC, pedestal hand basin with mixer tap, part tiled walls, heated towel rail, extractor fan and window with outlook to the front.

Double Garage 5.24m x 5.77m

With two up and over doors, light and power connected and two window with outlook to the rear.

Parking

Space for one vehicle

Key Features

- Detached Coach House
- Two Bedrooms
- In Immaculate Condition Throughout
- Double Garage
- Popular Location

Contact Us

Towers Wills Estate Agents - Yeovil
114, Hendford Hill
Yeovil
Somerset
BA202RF
T: 01935 577032
E: info@towerswills.co.uk

Energy Efficiency

Score	Energy rating	Current	Potential
92+	A		
81-91	B	81 B	81 B
69-80	C		
55-68	D		
39-54	E		
21-38	F		
1-20	G		



Floor Plan

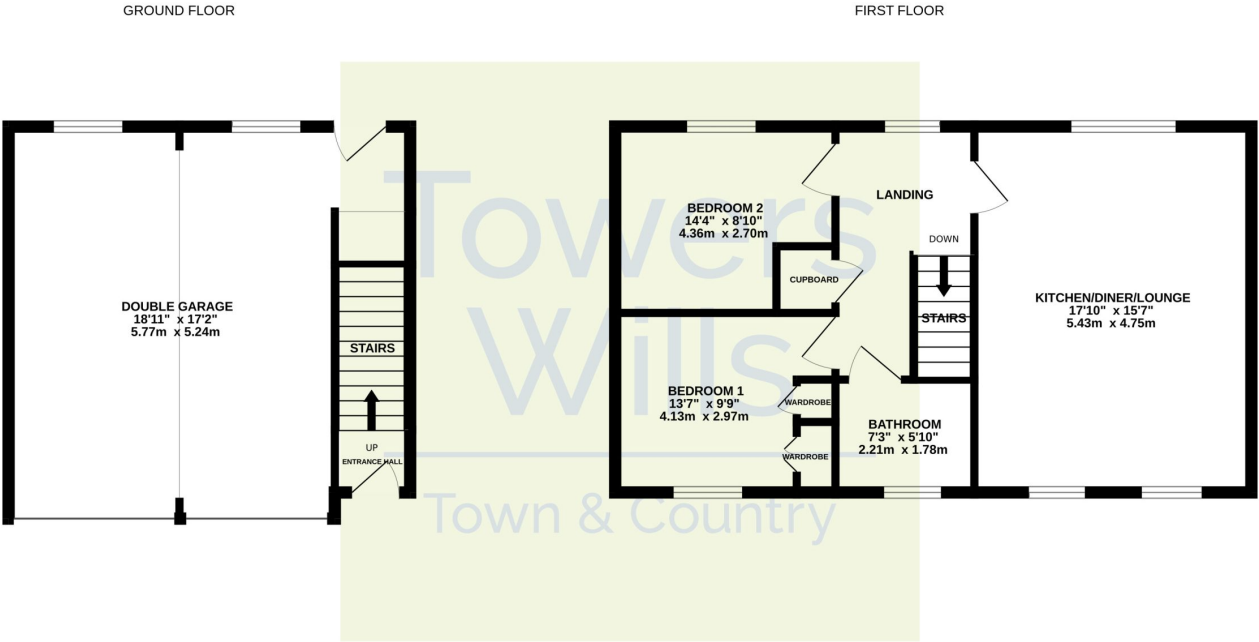

Whilst every attempt has been made to ensure the accuracy of the floorplan contained here, measurements of doors, windows, rooms and any other items are approximate and no responsibility is taken for any error, omission or mis-statement. This plan is for illustrative purposes only and should be used as such by any prospective purchaser. The services, systems and appliances shown have not been tested and no guarantee as to their operability or efficiency can be given.
Made with Metropix ©2025

Please Note No tests have been undertaken of any of the services and any intending purchasers should satisfy themselves in this regard. Towers Wills Ltd for themselves and for the vendor of this property whose agents they are, give notice that, (i) these particulars do not constitute any part of an offer or contract, (ii) all statements contained within these particulars are made without responsibility on the part of Towers Wills or the vendor, (iii) whilst made in good faith, none of the statements contained within these particulars are to be relied upon as a statement of representation or fact, (iv) any intending purchaser must satisfy him/herself by inspection or otherwise as to the correctness of each of the statements contained within these particulars, (v) the vendor does not make or give either Towers Wills or any person in their employment any authority to make or give representation or warranty whatsoever in relation to this property.

Photographs / Floor Plans Photographs are reproduced for general information and it must not be inferred that any item is included for sale with this property. Please note floor plans are not to scale and are for identification purposes only. The photographs used in these particulars may have been taken with the use of a wide angle lens. If you have any queries as to the size of the accommodation or plot, please address these with the agent prior to making an appointment to view

Towers Wills

The White House, 114 Hendford Hill, Yeovil BA20 2RF

Yeovil 01935 577032 / South Petherton 01460 298530

info@towerswills.co.uk | www.towerswills.co.uk