



18, Combe Park, Yeovil, Somerset BA21 3BD

£400,000

Towers Wills welcome to the market a rare opportunity to acquire a home of real quality and character in a prime location. Immaculately presented throughout, offering versatile accommodation including four double bedrooms(x2 ground floor, x2 first floor, en suite) living room, kitchen/ diner, utility room, bathroom, driveway and rear garden. Viewing is strongly advised to fully appreciate this beautiful home.

Description

Stunning Four-Bedroom Semi-Detached Chalet Bungalow in a Highly Desirable Location. Positioned in a sought-after and tranquil setting, this beautifully presented four-bedroom semi-detached chalet bungalow offers spacious, flexible accommodation ideal for modern family living.

To the ground floor, the property welcomes you with a porch leading into a spacious reception hallway. The living room features a charming wood-burning stove and opens into an extended seating area with a skylight and delightful views over the rear garden—creating a bright and relaxing space.

The contemporary, fully fitted kitchen offers space for an American-style fridge/freezer, and a range cooker with an extractor hood over, integrated dishwasher. A breakfast bar adds to the kitchen's functionality, while a comprehensive range of wall, base, and drawer units provides ample storage. The kitchen flows seamlessly into the dining room, which comfortably accommodates a dining table and chairs and offers direct access to the rear garden via a double-glazed door.

Also on the ground floor are two generous double bedrooms with fitted wardrobes, a stylish refitted bathroom, and a highly practical utility room.

Upstairs, the first floor features two further double bedrooms, including a superb master bedroom complete with fitted wardrobes and a modern en-suite shower room.

Outside, the property is equally impressive. A private driveway offers off-road parking for several vehicles. The rear garden is a true highlight—fully enclosed and enjoying an excellent degree of privacy. It is beautifully landscaped with a large lawn, a spacious patio area, an outdoor kitchen, and a timber cabin/summer house. Planted borders filled with a wide variety of mature shrubs and plants complete this idyllic outdoor retreat.

Early viewing is highly recommended.

Key Features

- Immaculately Presented
- Popular Location
- Four Bedrooms
- En-suite
- Gardens
- Driveway
- Early Viewing Advised

Contact Us

Towers Wills Estate Agents - Yeovil

114, Hendford Hill
Yeovil

Somerset

BA202RF

T: 01935 577032

E: info@towerswills.co.uk



Floor Plan

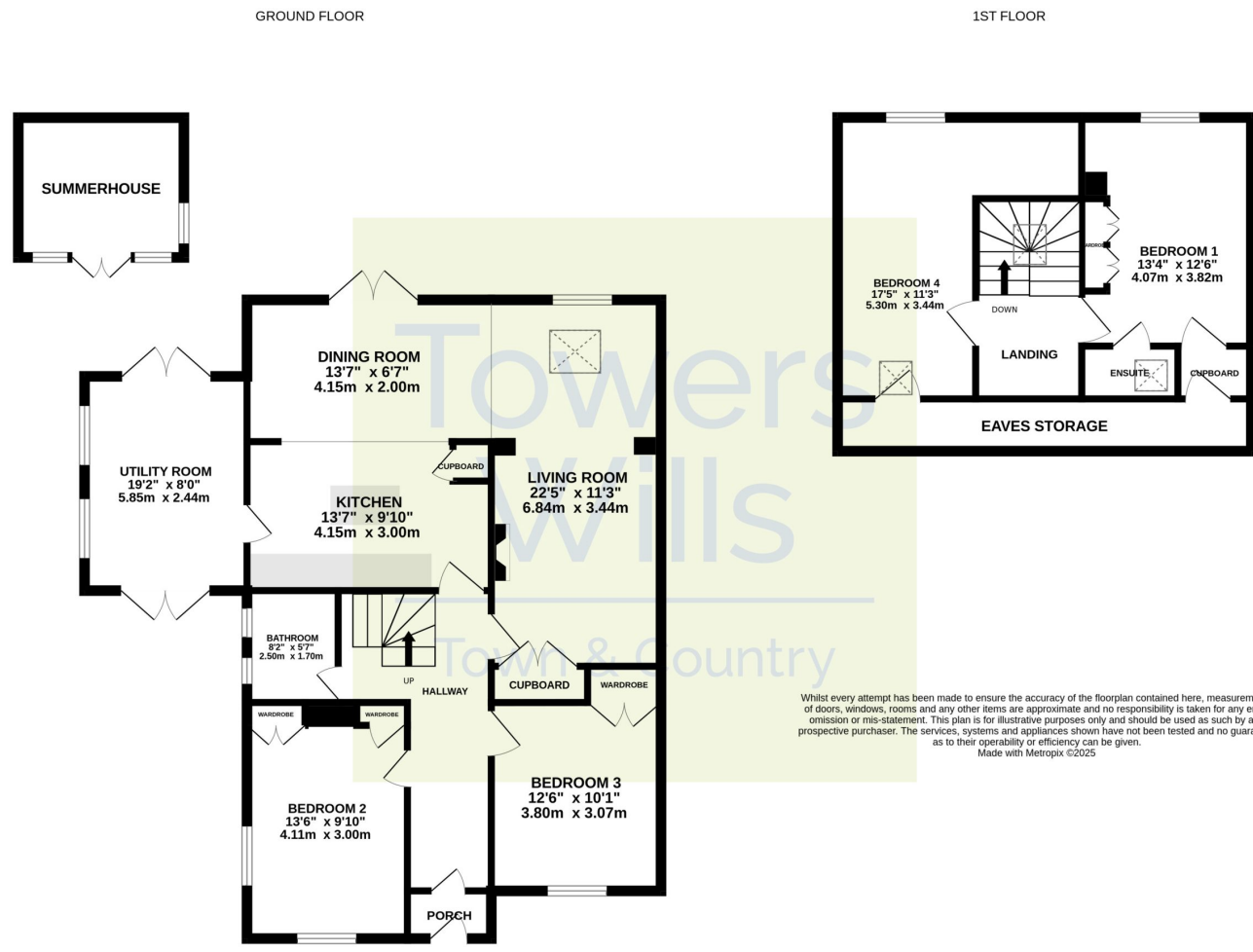

Please Note No tests have been undertaken of any of the services and any intending purchasers should satisfy themselves in this regard. Towers Wills Ltd for themselves and for the vendor of this property whose agents they are, give notice that, (i) these particulars do not constitute any part of an offer or contract, (ii) all statements contained within these particulars are made without responsibility on the part of Towers Wills or the vendor , (iii) whilst made in good faith, none of the statements contained within these particulars are to be relied upon as a statement of representation or fact , (iv) any intending purchaser must satisfy him/herself by inspection or otherwise as to the correctness of each of the statements contained within these particulars, (v) the vendor does not make or give either Towers Wills or any person in their employment any authority to make or give representation or warranty whatsoever in relation to this property.

Photographs / Floor Plans Photographs are reproduced for general information and it must not be inferred that any item is included for sale with this property. Please note floor plans are not to scale and are for identification purposes only. The photographs used in these particulars may have been taken with the use of a wide angle lens. If you have any queries as to the size of the accommodation or plot, please address these with the agent prior to making an appointment to view