

Towers Wills

Town & Country

📞 01935 577 032 | 01460 298 530 | ✉ info@towerswills.co.uk



80, Nelson Way, Yeovil, Somerset BA21 5DT

Offers Over £137,000

Towers Wills are pleased to offer to market this well presented two double bedroom first floor flat which is situated on the Wyndham Park Estate. The property briefly comprises; entrance hall, two double bedrooms with master en-suite, open plan kitchen/diner/lounge, balcony, family bathroom and allocated parking. The ideal first home or investment!

Hallway

Double built in storage cupboard, radiator, double glazed window to the side and a further storage cupboard

Lounge/ Kitchen/ Diner 5.63m x 3.69m

Lounge Area

Comprising double glazed patio doors to the balcony, TV point and Radiator.

Kitchen/ Dining Area

Comprising a range of wall, base and draw units, stainless sink with drainer and mixer tap, integrated oven with four ring gas hob and cooker hood over, space for wash machine, undercounter fridge & freezer, cupboard housing gas boiler, partly tiled, double glazed window to front and radiator.

Bedroom One 3.70m x 3.02m

Double glazed window to the front, integrated wardrobe, door to en-suite and radiator.

En-suite 1.58m x 1.91m

Comprising W/C, wash hand basin with vanity unit, shower cubicle, extractor fan, shaver point and wall mounted heated towel rail.

Bedroom Two 3.54m x 2.63m

Double glazed window to the front and a radiator.

Bathroom 1.72m x 2.15m

White panel bath with mixer tap and shower head attachment, wash hand basin, W/C, partly tiled, wall mounted heating towel rail and double glazed window to rear.

Parking

The property has one allocated parking space.

Agents Notes

The vendor has advised that the most recent fees for the property were:

Ground rent: Approx £200 per annum

Service Charge: Approx £1600 per annum

The property is selling with c. 142 years remaining on the lease

Key Features

- Ideal First Time Buy/Buy to Let
- Well Presented Throughout
- First Floor Flat
- Two Bedrooms
- En-suite
- Allocated Parking

Contact Us

Towers Wills Estate Agents - Yeovil
114, Hendford Hill
Yeovil
Somerset
BA202RF
T: 01935 577032
E: info@towerswills.co.uk

Energy Efficiency

Score	Energy rating	Current	Potential
92+	A		
81-91	B	83 B	83 B
69-80	C		
55-68	D		
39-54	E		
21-38	F		
1-20	G		



Floor Plan

GROUND FLOOR

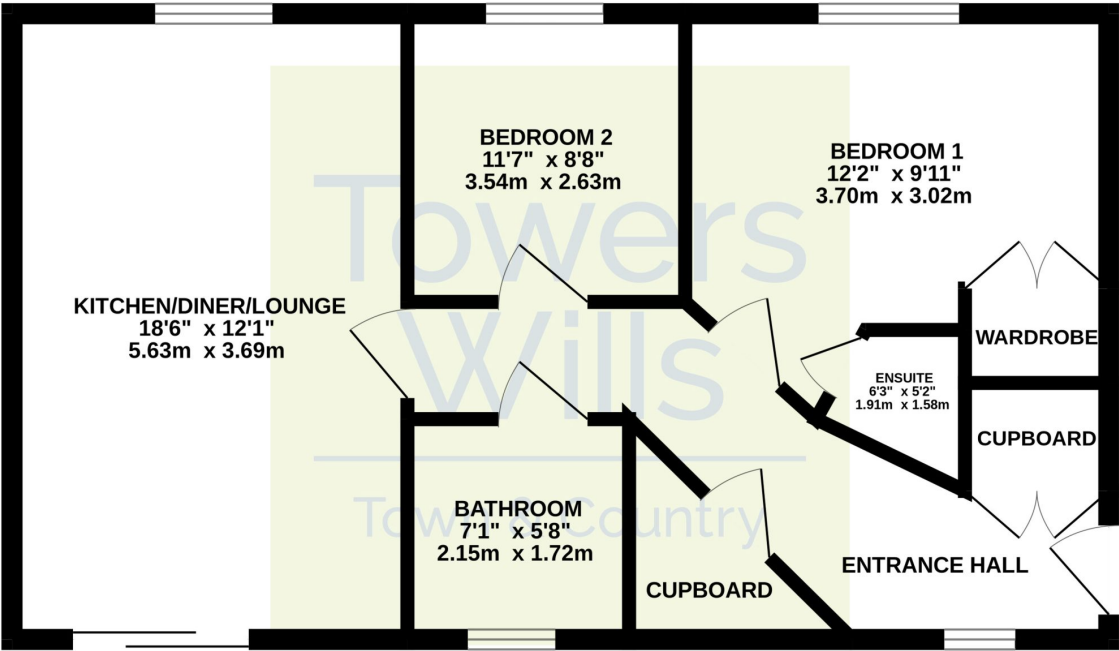

Whilst every attempt has been made to ensure the accuracy of the floorplan contained here, measurements of doors, windows, rooms and any other items are approximate and no responsibility is taken for any error, omission or mis-statement. This plan is for illustrative purposes only and should be used as such by any prospective purchaser. The services, systems and appliances shown have not been tested and no guarantee as to their operability or efficiency can be given.
Made with Metropix ©2025

Please Note No tests have been undertaken of any of the services and any intending purchasers should satisfy themselves in this regard. Towers Wills Ltd for themselves and for the vendor of this property whose agents they are, give notice that, (i) these particulars do not constitute any part of an offer or contract, (ii) all statements contained within these particulars are made without responsibility on the part of Towers Wills or the vendor , (iii) whilst made in good faith, none of the statements contained within these particulars are to be relied upon as a statement of representation or fact , (iv) any intending purchaser must satisfy him/herself by inspection or otherwise as to the correctness of each of the statements contained within these particulars, (v) the vendor does not make or give either Towers Wills or any person in their employment any authority to make or give representation or warranty whatsoever in relation to this property.

Photographs / Floor Plans Photographs are reproduced for general information and it must not be inferred that any item is included for sale with this property. Please note floor plans are not to scale and are for identification purposes only. The photographs used in these particulars may have been taken with the use of a wide angle lens. If you have any queries as to the size of the accommodation or plot, please address these with the agent prior to making an appointment to view

Towers Wills

The White House, 114 Hendford Hill, Yeovil BA20 2RF

Yeovil 01935 577032 / South Petherton 01460 298530

info@towerswills.co.uk | www.towerswills.co.uk