

# Towers Wills

Town & Country

📞 01935 577 032 | 01460 298 530 | ✉ info@towerswills.co.uk



**15, Castle Street, Stoke-sub-Hamdon, Somerset  
TA14 6RE**

**£315,000**

Towers Wills are pleased to welcome to market this attractive period Hamstone terrace cottage, situated in the popular village location of Stoke Sub Hamdon and within close proximity to Ham Hill-Natural beauty spot. The property also offers a range of character features including tiled flooring, feature fireplaces, stripped wood flooring and feature Hamstone walls. The cottage comprises; entrance hall, sitting room, open plan kitchen/diner, three double bedrooms, master bedroom with en-suite, family bathroom and enclosed rear garden with pleasant rear aspect. Stoke Sub Hamdon offers a good range of amenities including; doctor's surgery and schools.

## Entrance Hall

Panel door to the front, stone flooring and stairs to the first floor.

## Lounge 3.51m x 3.68m

Wooden sash window to the front, log burner with surround and radiator.

## Kitchen/Diner

### Dining Area 3.79m x 3.78m

Exposed wooden floorboards, under stairs cupboard, wood burner and space for tumble dryer.

### Kitchen Area 5.56m x 4.26m

A stunning centre piece of the home offering a versatile entertainment space for all friends and family to enjoy. A quality fitted kitchen comprising of a range of wall, base and drawer units, work surfacing with porcelain sink and mixer tap, integrated oven with five-ring gas hob and cookerhood over, integrated dishwasher, integrated washing machine, space for American style fridge freezer, island unit with wooden worktop and further cupboards and drawer units, double glazed patio doors leading to the garden and skylight.

## First Floor Landing

Double glazed window to the rear, stairs to the second floor and under stairs cupboard.

## Bedroom Three

Wooden sash window to the rear, built-in wardrobe and radiator.

## Bedroom Two 3.12m x 3.77m

Wooden sash window to the front, feature fireplace and radiator.

## Family Bathroom 2.56m x 1.57m

White bathroom suite comprising of bath with overhead shower, wash hand basin with vanity unit, w.c, tiled floor, part wooden panelling and window to the

## Second Floor Landing

Door to master bedroom and eaves storage.

## Master Bedroom 3.37m x 4.18m

Two double glazed skylights, radiator, eaves storage and door to en-suite.

## En-suite 1.83m x 1.29m

Comprising freestanding shower, wash hand basin, w.c, wall mounted heated towel rail, skylight to the front and tiled floor.

## Rear Garden

To the rear the garden is mainly laid to lawn with decked seating area and space for shed.

## Key Features

- Period Hamstone Cottage
- Sought-after Village Location
- Large Open Plan Kitchen/Diner
- Three Double Bedrooms
- Master En-suite
- Rear Garden
- Two Log Burners
- Views to Ham Hill from Attic Bedroom

## Contact Us

### Towers Wills Estate Agents - Yeovil

114, Hendford Hill  
Yeovil

Somerset

BA202RF

T: 01935 577032

E: [info@towerswills.co.uk](mailto:info@towerswills.co.uk)



# Floor Plan

GROUND FLOOR  
410 sq.ft. (38.1 sq.m.) approx.

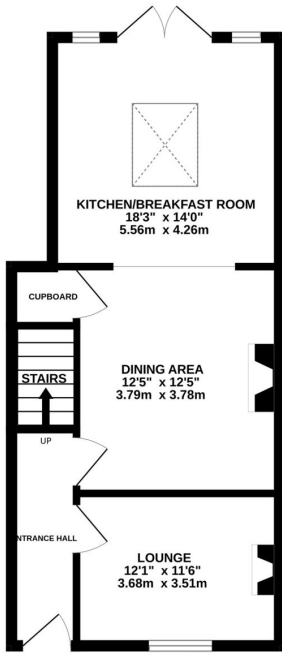

1ST FLOOR  
266 sq.ft. (24.7 sq.m.) approx.

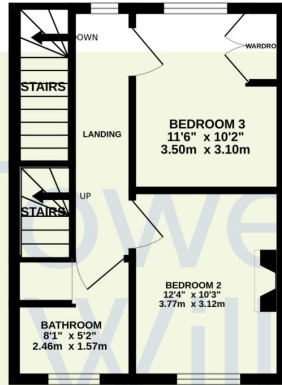

2ND FLOOR  
244 sq.ft. (22.7 sq.m.) approx.

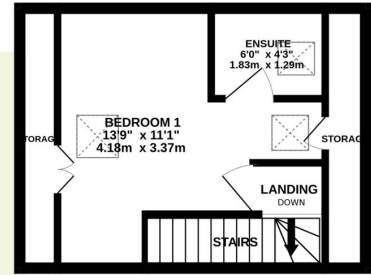

TOTAL FLOOR AREA : 920 sq.ft. (85.5 sq.m.) approx.

Whilst every attempt has been made to ensure the accuracy of the floorplan contained here, measurements of doors, windows, rooms and any other items are approximate and no responsibility is taken for any error, omission or mis-statement. This plan is for illustrative purposes only and should be used as such by any prospective purchaser. The services, systems and appliances shown have not been tested and no guarantee as to their operability or efficiency can be given.  
Made with Metropix ©2024

Please Note No tests have been undertaken of any of the services and any intending purchasers should satisfy themselves in this regard. Towers Wills Ltd for themselves and for the vendor of this property whose agents they are, give notice that, (i) these particulars do not constitute any part of an offer or contract, (ii) all statements contained within these particulars are made without responsibility on the part of Towers Wills or the vendor, (iii) whilst made in good faith, none of the statements contained within these particulars are to be relied upon as a statement of representation or fact, (iv) any intending purchaser must satisfy him/herself by inspection or otherwise as to the correctness of each of the statements contained within these particulars, (v) the vendor does not make or give either Towers Wills or any person in their employment any authority to make or give representation or warranty whatsoever in relation to this property.

Photographs / Floor Plans Photographs are reproduced for general information and it must not be inferred that any item is included for sale with this property. Please note floor plans are not to scale and are for identification purposes only. The photographs used in these particulars may have been taken with the use of a wide angle lens. If you have any queries as to the size of the accommodation or plot, please address these with the agent prior to making an appointment to view

**Towers Wills**

The White House, 114 Hendford Hill, Yeovil BA20 2RF

Yeovil 01935 577032 / South Petherton 01460 298530

[info@towerswills.co.uk](mailto:info@towerswills.co.uk) | [www.towerswills.co.uk](http://www.towerswills.co.uk)