

Towers Wills

Town & Country

📞 01935 577 032 | 01460 298 530 | ✉ info@towerswills.co.uk



19, Ambrose Close, Bradford Abbas, Sherborne,
Dorset DT9 6RL

£210,000

Towers Wills welcome to market this end of terrace bungalow situated in the desirable village of Bradford Abbas on the outskirts of Sherborne. The property benefits from driveway parking, garden, two bedrooms, sitting room, shower room and kitchen.

Entrance Hall

Double glazed door to the front, electric wall mounted radiator, storage cupboard and loft hatch.

Bedroom One 3.09m x 3.67m

Double glazed window to the front and electric wall mounted radiator.

Shower Room 2.58m x 1.53m

Comprising shower cubicle with electric shower, wash hand basin, w.c, double glazed window to the rear, electric wall mounted radiator and extractor fan.

Sitting Room 4.12m x 3.36m - maximum measurements

Double glazed windows to the front and side and electric wall mounted radiator.

Bedroom Two 2.44m x 3.33m - maximum measurements

Double glazed window to the front, one fitted double wardrobe, one fitted cupboard and electric wall mounted radiator.

Kitchen 3.67m x 3.26m - maximum measurements

Comprising of a range of wall, base and drawer units, work surfacing with one bowl sink drainer, two double glazed windows to the rear, double glazed door to the rear/drive, electric wall mounted radiator, integrated electric oven, integrated electric hob with extractor over, space for washing machine, integrated fridge freezer and cupboard.

Outside

The garden is situated to the front of the property and is largely laid to lawn with a driveway to the side/rear of the property, offering ample off road parking.

Key Features

- Desirable Village Location
- Two Bedrooms
- Shower Room
- Driveway Parking

Contact Us

Towers Wills Estate Agents - Yeovil

114, Hendford Hill
Yeovil

Somerset
BA202RF

T: 01935 577032

E: info@towerswills.co.uk

Energy Efficiency

Score	Energy rating	Current	Potential
92+	A		
81-91	B		85 B
69-80	C		
55-68	D		
39-54	E	41 E	
21-38	F		
1-20	G		



Floor Plan

GROUND FLOOR

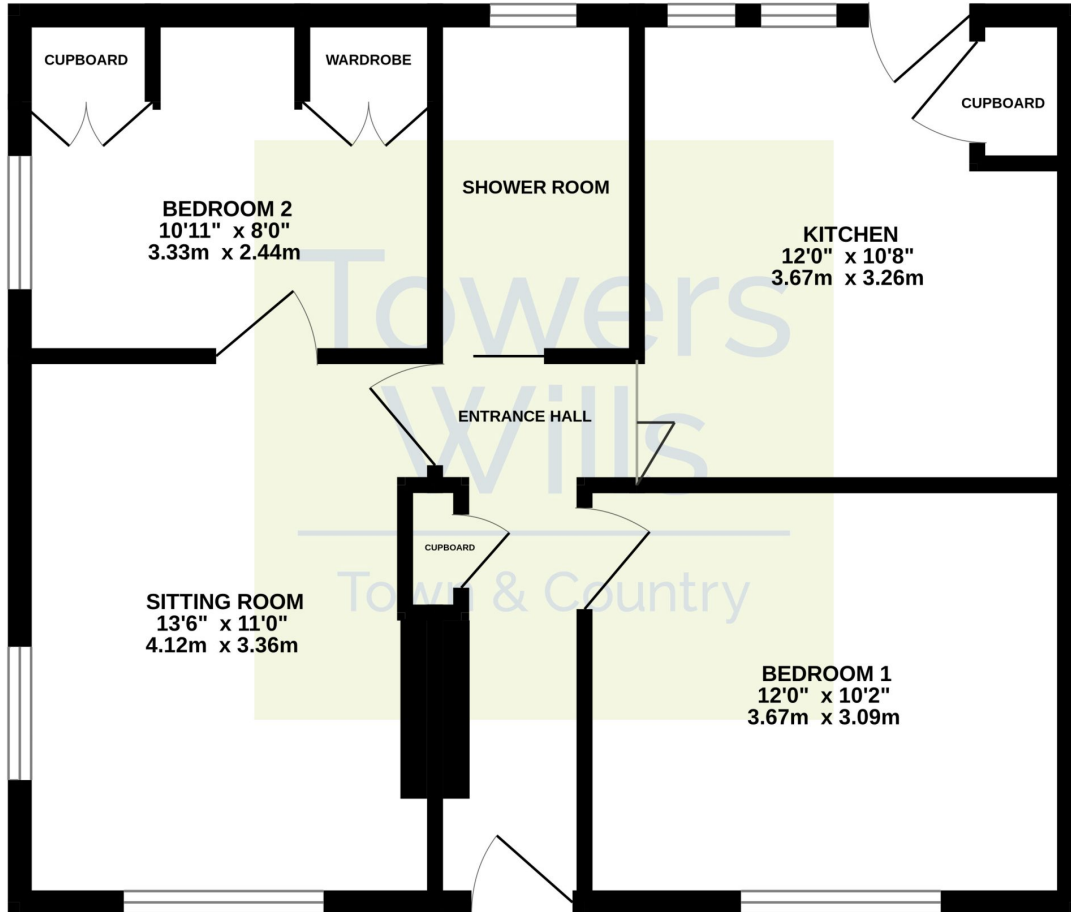

Whilst every attempt has been made to ensure the accuracy of the floorplan contained here, measurements of doors, windows, rooms and any other items are approximate and no responsibility is taken for any error, omission or mis-statement. This plan is for illustrative purposes only and should be used as such by any prospective purchaser. The services, systems and appliances shown have not been tested and no guarantee as to their operability or efficiency can be given.
Made with Metropix ©2024

Please Note No tests have been undertaken of any of the services and any intending purchasers should satisfy themselves in this regard. Towers Wills Ltd for themselves and for the vendor of this property whose agents they are, give notice that, (i) these particulars do not constitute any part of an offer or contract, (ii) all statements contained within these particulars are made without responsibility on the part of Towers Wills or the vendor, (iii) whilst made in good faith, none of the statements contained within these particulars are to be relied upon as a statement of representation or fact, (iv) any intending purchaser must satisfy him/herself by inspection or otherwise as to the correctness of each of the statements contained within these particulars, (v) the vendor does not make or give either Towers Wills or any person in their employment any authority to make or give representation or warranty whatsoever in relation to this property.

Photographs / Floor Plans Photographs are reproduced for general information and it must not be inferred that any item is included for sale with this property. Please note floor plans are not to scale and are for identification purposes only. The photographs used in these particulars may have been taken with the use of a wide angle lens. If you have any queries as to the size of the accommodation or plot, please address these with the agent prior to making an appointment to view

Towers Wills

The White House, 114 Hendford Hill, Yeovil BA20 2RF

Yeovil 01935 577032 / South Petherton 01460 298530

info@towerswills.co.uk | www.towerswills.co.uk