

Towers Wills

Town & Country

📞 01935 577 032 | 01460 298 530 | ✉ info@towerswills.co.uk



80, Rowan Way, Yeovil, Somerset BA20 2NS

£365,000

Towers Wills are pleased to offer to market this spacious three bedroom detached property, in need of light modernisation and situated in a highly desirable location offering a short walk to many local amenities. The property briefly comprises; entrance hall, kitchen/diner, lounge, downstairs w.c, three bedrooms, family bathroom, low maintenance rear garden, off road parking and garage.

Entrance Hall

Double glazed door to the front, stairs to the first floor, laminate flooring, under stairs cupboard and radiator.

Lounge 6.01m x 3.31m

Double glazed window to the front, door to conservatory and two radiators.

Conservatory 3.02m x 2.84m

Single glazed sliding door to the garden.

Downstairs W.C 1.79m x 1.04m

With low level w.c, wash hand basin with vanity unit laminate flooring, radiator and double glazed window to the rear.

Kitchen/Diner 5.35m x 2.64m

Comprising of a range of wall, base and drawer units, work surfacing with stainless steel sink with mixer tap, double glazed windows to the front and rear, space for fridge freezer, washing machine and dishwasher, radiator integrated oven with induction hob and cookerhood over.

First Floor Landing

Loft access.

Bedroom One 3.31m x 3.46m

Double glazed window to the front, fitted cupboards and radiator.

Bedroom Two 3.14m x 3.17m

Double glazed window to the front, fitted cupboard and radiator.

Bedroom Three 2.41m x 2.23m

Double glazed window to the rear, radiator and exposed wooden floorboards.

Wet Room 2.04m x 1.96m

Suite comprising walk-in shower, wash hand basin with vanity unit, low level w.c, radiator and double glazed window to the rear.

Rear Garden

The rear garden is mainly laid to patio with rear gate leading to the parking and garage.

Parking

There is off road parking for several vehicles.

Garage

With 'up and over' door.

Key Features

- Sought-after Location
- Detached
- Three Bedrooms
- Garden
- Garage & Driveway

Contact Us

Towers Wills Estate Agents - Yeovil

114, Hendford Hill

Yeovil

Somerset

BA202RF

T: 01935 577032

E: info@towerswills.co.uk



Floor Plan

GROUND FLOOR
547 sq.ft. (50.8 sq.m.) approx.

1ST FLOOR
494 sq.ft. (45.9 sq.m.) approx.

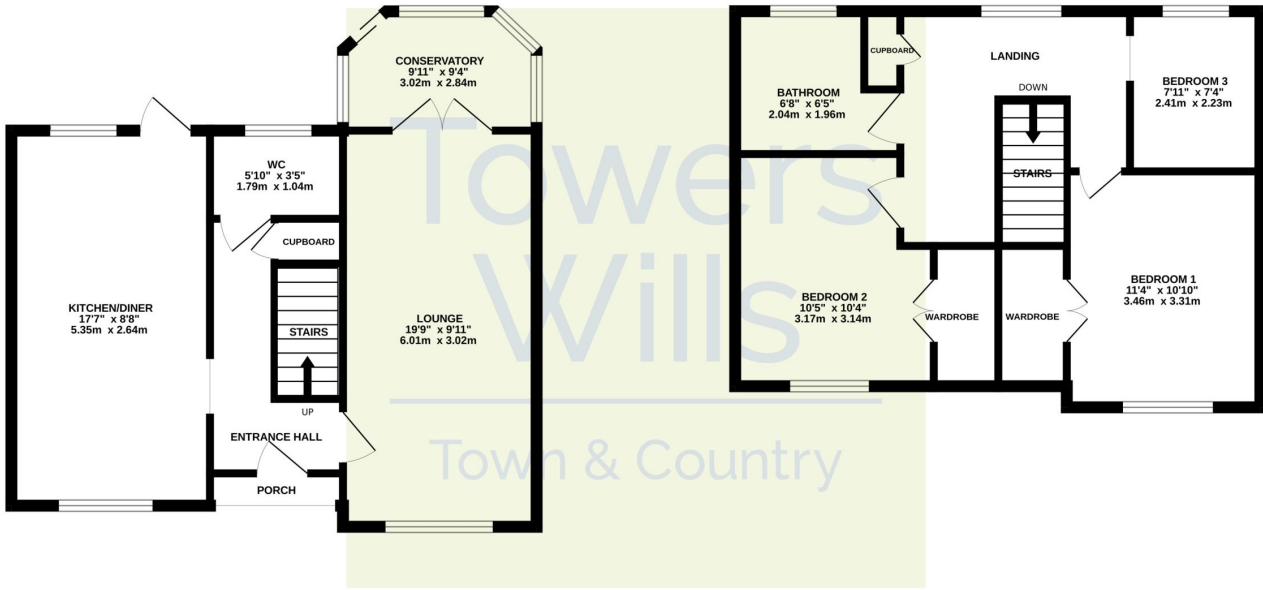

TOTAL FLOOR AREA : 1040 sq.ft. (96.7 sq.m.) approx.

Whilst every attempt has been made to ensure the accuracy of the floorplan contained here, measurements of doors, windows, rooms and any other items are approximate and no responsibility is taken for any error, omission or mis-statement. This plan is for illustrative purposes only and should be used as such by any prospective purchaser. The services, systems and appliances shown have not been tested and no guarantee as to their operability or efficiency can be given.
Made with Metropix ©2024

Please Note No tests have been undertaken of any of the services and any intending purchasers should satisfy themselves in this regard. Towers Wills Ltd for themselves and for the vendor of this property whose agents they are, give notice that, (i) these particulars do not constitute any part of an offer or contract, (ii) all statements contained within these particulars are made without responsibility on the part of Towers Wills or the vendor, (iii) whilst made in good faith, none of the statements contained within these particulars are to be relied upon as a statement of representation or fact, (iv) any intending purchaser must satisfy him/herself by inspection or otherwise as to the correctness of each of the statements contained within these particulars, (v) the vendor does not make or give either Towers Wills or any person in their employment any authority to make or give representation or warranty whatsoever in relation to this property.

Photographs / Floor Plans Photographs are reproduced for general information and it must not be inferred that any item is included for sale with this property. Please note floor plans are not to scale and are for identification purposes only. The photographs used in these particulars may have been taken with the use of a wide angle lens. If you have any queries as to the size of the accommodation or plot, please address these with the agent prior to making an appointment to view

Towers Wills

The White House, 114 Hendford Hill, Yeovil BA20 2RF

Yeovil 01935 577032 / South Petherton 01460 298530

info@towerswills.co.uk | www.towerswills.co.uk