

Towers Wills

Town & Country

📞 01935 577 032 | 01460 298 530 | ✉ info@towerswills.co.uk



38, Percivale Road, Yeovil, Somerset BA21 3GZ

£160,000

Towers Wills are pleased to offer to market this delightfully presented, two bedroom ground floor apartment, situated on the west side of Yeovil and offering easy convenience to many local amenities including shops, schools and public house. The property briefly comprises; entrance hall, lounge, kitchen, two double bedrooms with ensuite to the master bedroom, family bathroom and allocated parking. Ideal for a First Time Buyer or investor.

Entrance Hall

Two double storage cupboards, radiator and intercom system.

Lounge 3.96m x 4.94m

With two double glazed windows to the rear, radiator and door to kitchen.

Kitchen 1.82m x 3.02m

Comprising of a range of wall, base and drawer units, work surfacing with sink/drainers, integrated oven with four ring gas hob and cookerhood over, space for washing machine, space for tumble dryer, space for fridge freezer, boiler, radiator and double glazed window to the side.

Bedroom One 3.23m x 2.88m

Double glazed window to the side, fitted wardrobes and radiator.

En-suite

Suite comprising walk-in shower, wash hand basin, low level w.c, part tiled walls, radiator and extractor fan.

Bedroom Two 2.50m x 3.84m

Double glazed window to the side, fitted wardrobes and radiator.

Bathroom 1.73m x 2.14m

Suite comprising white panel bath with shower over, wash hand basin, low level w.c, extractor fan and radiator.

Parking

There is one allocated parking space.

Agents Note

The current owner has made us aware of the following lease details:

108 years remaining on the lease

Service charges - £756 per annum

Ground rent - £200 per annum

Key Features

- Ground Floor Apartment
- Two Double Bedrooms
- Master En-suite
- Allocated Parking
- Ideal First Time Buy/Investment Opportunity

Contact Us

Towers Wills Estate Agents - Yeovil

114, Hendford Hill
Yeovil

Somerset

BA202RF

T: 01935 577032

E: info@towerswills.co.uk



Floor Plan

GROUND FLOOR
674 sq.ft. (62.6 sq.m.) approx.

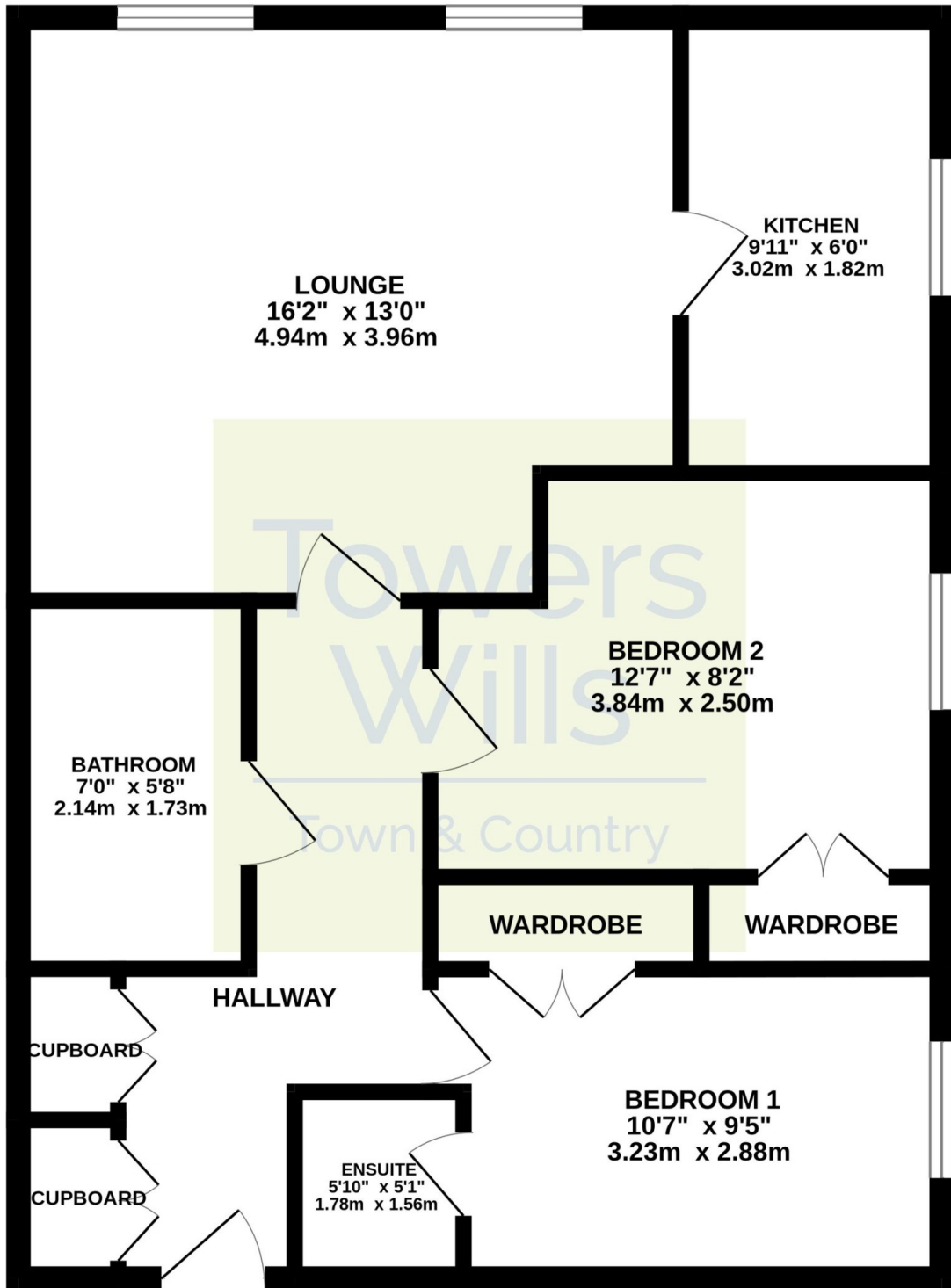

TOTAL FLOOR AREA : 674 sq.ft. (62.6 sq.m.) approx.

Whilst every attempt has been made to ensure the accuracy of the floorplan contained here, measurements of doors, windows, rooms and any other items are approximate and no responsibility is taken for any error, omission or mis-statement. This plan is for illustrative purposes only and should be used as such by any prospective purchaser. The services, systems and appliances shown have not been tested and no guarantee as to their operability or efficiency can be given.
Made with Metropix ©2024

Please Note No tests have been undertaken of any of the services and any intending purchasers should satisfy themselves in this regard. Towers Wills Ltd for themselves and for the vendor of this property whose agents they are, give notice that, (i) these particulars do not constitute any part of an offer or contract, (ii) all statements contained within these particulars are made without responsibility on the part of Towers Wills or the vendor, (iii) whilst made in good faith, none of the statements contained within these particulars are to be relied upon as a statement of representation or fact, (iv) any intending purchaser must satisfy him/herself by inspection or otherwise as to the correctness of each of the statements contained within these particulars, (v) the vendor does not make or give either Towers Wills or any person in their employment any authority to make or give representation or warranty whatsoever in relation to this property.

Photographs / Floor Plans Photographs are reproduced for general information and it must not be inferred that any item is included for sale with this property. Please note floor plans are not to scale and are for identification purposes only. The photographs used in these particulars may have been taken with the use of a wide angle lens. If you have any queries as to the size of the accommodation or plot, please address these with the agent prior to making an appointment to view

Towers Wills

The White House, 114 Hendford Hill, Yeovil BA20 2RF

Yeovil 01935 577032 / South Petherton 01460 298530

info@towerswills.co.uk | www.towerswills.co.uk