

Hartington Villas

Hove

LEXTONS / SALES
LETTINGS
AUCTIONS
COMMERCIAL



About the property

A well-presented one-bedroom flat ideally located just a short walk from Hove Park and Hove Station. Recently painted and newly carpeted throughout, the property offers a fresh and modern living environment.

The living room is bright and welcoming, with large windows that allow plenty of natural light. The bedroom is a good size and can comfortably accommodate plenty of furniture. The bathroom features a full-sized bath with an overhead shower, and the separate kitchen comes fully equipped with white goods.

This property is available now and would be perfect for a professional or couple looking to live in a desirable part of Hove. Early viewing is recommended.

Hartington Villas Hove

£1,500



1

BEDROOM

1

RECEPTION

1

BATHROOM





SCAN HERE TO VIEW ALL AVAILABLE PROPERTIES

First Floor
Approx. 46.0 sq. metres (495.2 sq. feet)

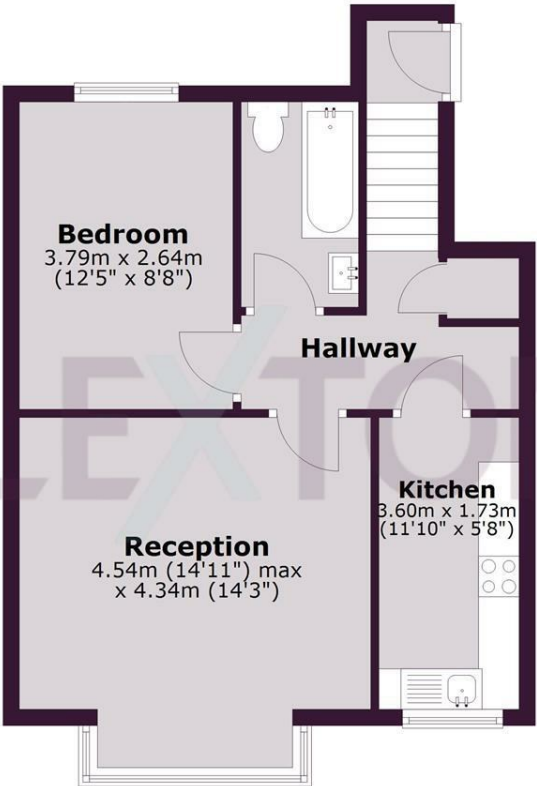

Total area: approx. 46.0 sq. metres (495.2 sq. feet)

Whilst every care has been taken to ensure accuracy, dimensions are approximate and for illustrative purposes only.
Created for exclusive use for Lextons. All rights reserved.
Plan produced using PlanUp.

Energy Efficiency Rating		
	Current	Potential
Very energy efficient - lower running costs		
(92 plus) A		
(81-91) B		
(69-80) C		
(55-68) D		
(39-54) E		
(21-38) F		
(1-20) G		
Not energy efficient - higher running costs		
England & Wales		EU Directive 2002/91/EC