

Cambridge Road

Eastbourne



About the property

A beautifully presented one-bedroom ground floor flat located just moments from Eastbourne's picturesque seafront. This charming property offers a bright and modern open-plan kitchen and living area, which opens directly onto a private patio garden—ideal for enjoying the fresh sea air or alfresco dining. The bedroom area provides a comfortable and well-proportioned space, while the contemporary bathroom features a stylish walk-in shower. Set in a highly sought-after location close to local amenities, shops, and transport links, this flat is perfect for those seeking a coastal lifestyle with convenience and comfort.

Early viewing is highly recommended.

Cambridge Road Eastbourne

£1,050 Per month



1

BEDROOM

1

RECEPTION

1

BATHROOM





SCAN HERE TO VIEW ALL AVAILABLE PROPERTIES

Ground Floor

Approx. 39.7 sq. metres (427.6 sq. feet)

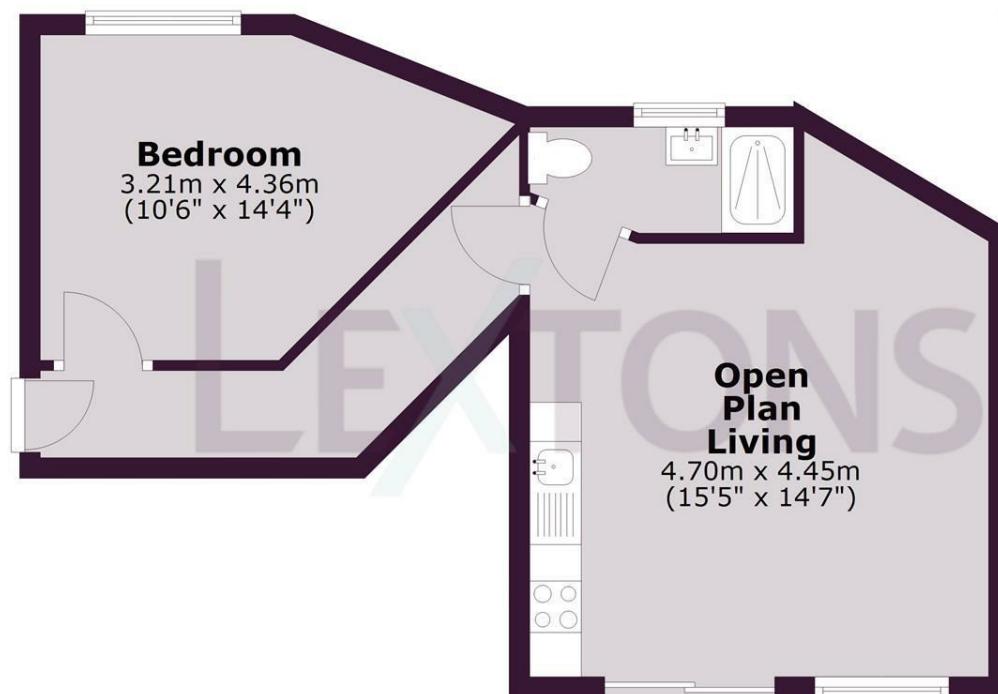

Total area: approx. 39.7 sq. metres (427.6 sq. feet)

Whilst every care has been taken to ensure accuracy, dimensions are approximate and for illustrative purposes only.

Created for exclusive use for Lextons. All rights reserved.

Plan produced using PlanUp.

| Energy Efficiency Rating | | |
|---|---------|-------------------------|
| | Current | Potential |
| Very energy efficient - lower running costs | | |
| (92 plus) A | | |
| (81-91) B | | |
| (69-80) C | | 70 |
| (55-68) D | 55 | |
| (39-54) E | | |
| (21-38) F | | |
| (1-20) G | | |
| Not energy efficient - higher running costs | | |
| England & Wales | | EU Directive 2002/91/EC |