

Lansdowne Street

Hove

LEXTONS /
SALES
LETTINGS
AUCTIONS
COMMERCIAL



About the property

A beautifully presented one-bedroom apartment, ideally positioned on the first floor of a well-maintained period building in the heart of Central Hove. Just moments from the vibrant array of restaurants, bars, and independent shops along Western Road and Church Road, this stylish home also offers easy access to the seafront and excellent transport links, including Hove Station.

The apartment features a bright and inviting living room, complemented by elegant sash bay windows that flood the space with natural light and offer a charming outlook. The modern kitchen is thoughtfully designed with sleek units, ample storage, and integrated appliances, perfect for home cooking and entertaining.

The generous double bedroom provides a peaceful retreat with plenty of space for additional furnishings or storage. A contemporary white bathroom suite completes the property, finished to a high standard with clean, neutral tones.

Lansdowne Street Hove

£1,250 Per month

1

BEDROOM

1

RECEPTION

1

BATHROOM



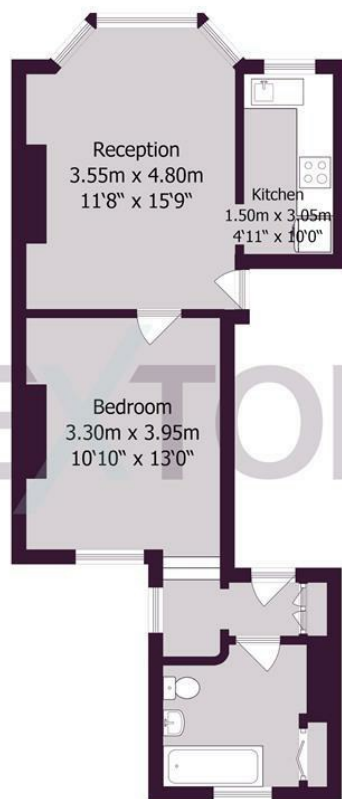

Approximate gross internal floor area 45 sq m/ 484 sq ft

Whilst every care has been taken to ensure accuracy,
dimensions are approximate and for illustrative purposes only.

Created by Property Photography UK for Lextons. All rights reserved.

SCAN HERE TO VIEW ALL AVAILABLE PROPERTIES



Energy Efficiency Rating		
	Current	Potential
Very energy efficient - lower running costs		
(92 plus) A		
(81-91) B		
(69-80) C		
(55-68) D		
(39-54) E		
(21-38) F		
(1-20) G		
Not energy efficient - higher running costs		
England & Wales		
		EU Directive 2002/91/EC