

# Princes Terrace

## Brighton



# Princes Terrace Brighton

£1,750 Per month



2

BEDROOM

2

RECEPTION

1

BATHROOM

## About the property

A bright and exceptionally spacious two-bedroom maisonette, featuring a private rear garden and its own street entrance, ideally located in Kemptown.

Entering through the private entrance, a welcoming hallway provides access to all rooms. On the ground floor, you'll find an impressive double reception room stretching from the front to the rear of the property—perfect for use as two distinct living spaces. Large windows at both ends fill the space with natural light, making it ideal for entertaining.

To the rear of the property is a well-appointed kitchen with a range of wall-mounted and base units, as well as direct access to a private west-facing garden—perfect for outdoor dining and relaxation.

Upstairs, the first floor offers two generous double bedrooms. The principal bedroom is notably larger than average for the area. A stylish, modern family bathroom completes the upper floor.

Other benefits include: Gas central heating and brand new double glazed windows throughout.

Early viewings are highly recommended to avoid disappointment.















SCAN HERE TO VIEW ALL AUCTION PROPERTIES

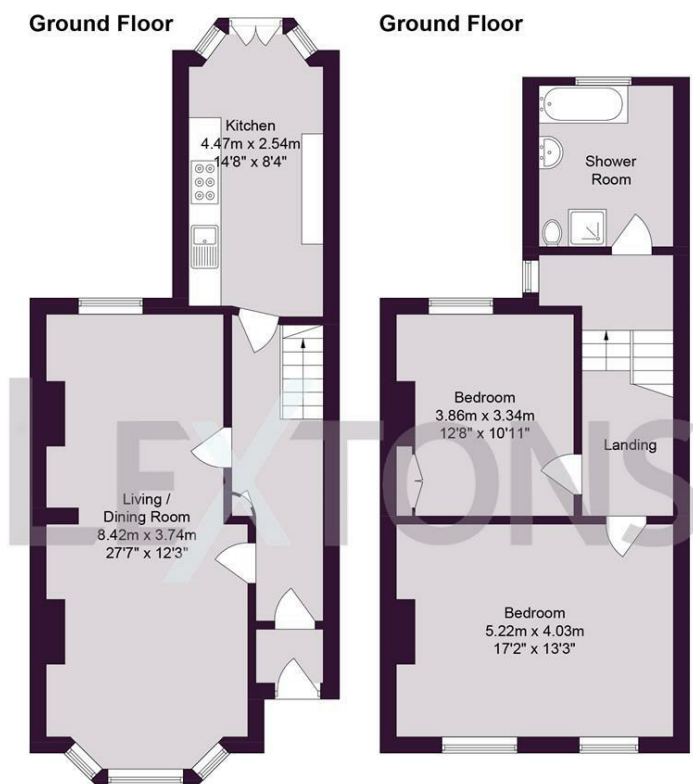

Approximate Gross Internal Area = 104.1 sq m / 1120 sq ft

Whilst every care has been taken to ensure accuracy, dimensions are approximate and for illustrative purposes only.

Whilst every care has been taken to ensure accuracy, dimensions are approximate and for illustrative purposes only.

Created by Lextons. All rights reserved.

