

Westbourne Street

Hove

LEXTONS /
SALES
LETTINGS
AUCTIONS
COMMERCIAL



About the property

This charming one-bedroom garden apartment is set within an elegant period house in the highly sought-after Poets Corner neighborhood of Hove. Brimming with character, the property presents an excellent opportunity for modernisation while retaining its beautiful original features, including high ceilings and period detailing. The interiors are bright and airy, creating a welcoming atmosphere, while the generously sized kitchen area offers ample scope for transformation.

The rear garden is a standout feature, providing a private outdoor retreat with a side return that enhances storage possibilities. Situated on a peaceful residential road in the heart of Poets Corner, the apartment is just a short stroll from the seafront and within easy reach of the vibrant restaurants, bars, and independent shops along Portland Road, Blatchington Road, and Church Road. Well-regarded local schools include Hove Junior School, St. Andrew's C of E Primary School, St. Christopher's School, and Brunswick Primary School.

Westbourne Street Hove

£270,000



1

BEDROOM

1

RECEPTION

1

BATHROOM









SCAN HERE TO OFFER ON THIS PROPERTY

Ground Floor

Approx. 46.6 sq. metres (501.1 sq. feet)

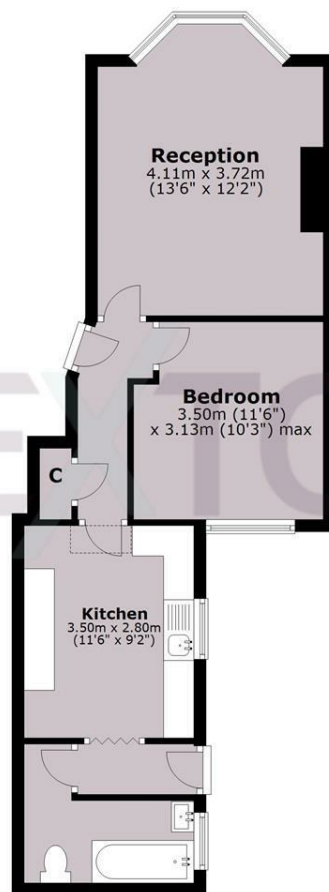

Total area: approx. 46.6 sq. metres (501.1 sq. feet)

Energy Efficiency Rating		
	Current	Potential
Very energy efficient - lower running costs		
(92 plus) A		
(81-91) B		
(69-80) C		
(55-68) D		
(39-54) E		
(21-38) F		
(1-20) G		
Not energy efficient - higher running costs		
England & Wales		EU Directive 2002/91/EC