

# Chapel Mews

## Hove

**LEX**TONS /  
SALES  
LETTINGS  
AUCTIONS  
COMMERCIAL



## About the property

Chapel Mews is a beautiful two-bedroom maisonette in Central Hove, featuring a private entrance and an allotted parking space. The property has been stylishly decorated throughout.

At the front of the property, the generously sized master bedroom boasts a large sash window and whitewashed wooden flooring, creating a bright and airy atmosphere. Adjacent is the charming reception room, complete with double sliding doors and a sleek minimalist fireplace.

The second bedroom, located at the rear, includes built-in storage and offers lovely views of the church. Next to it, the family bathroom provides both bath and shower facilities. The separate kitchen features ample storage and counter space, making it a functional and inviting space.

Chapel Mews is superbly located, surrounded by fantastic amenities, including Hove Seafront, Waitrose, and a variety of independent shops, cafés, restaurants, and pubs. The property is also within minutes of several excellent primary and secondary schools, with both Brighton and Hove stations easily accessible.

# Chapel Mews Hove

£1,850 Per month



2

BEDROOM

1

RECEPTION

1

BATHROOM











SCAN HERE TO VIEW ALL AVAILABLE PROPERTIES

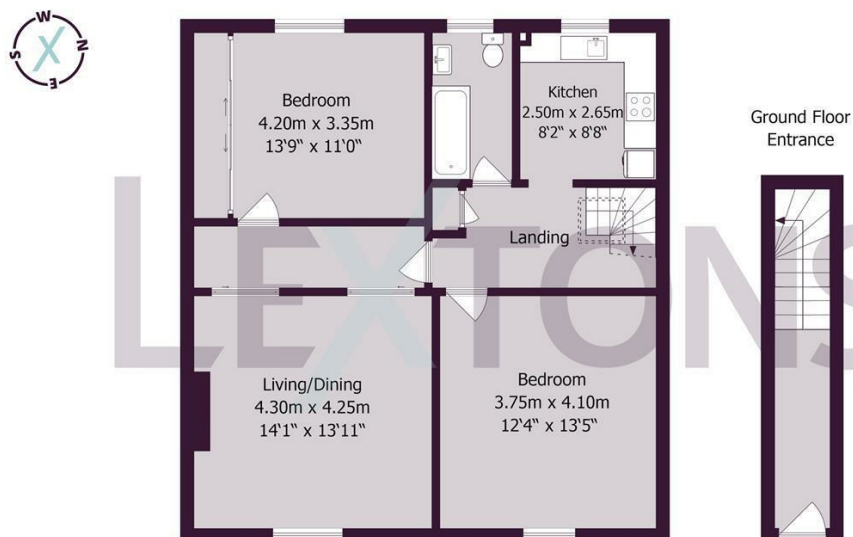

Approximate gross internal floor area 81.5 sq m/ 877 sq ft

Whilst every care has been taken to ensure accuracy, dimensions are approximate and for illustrative purposes only.

Created by Property Photography UK for Lextons. All rights reserved.

