

Old London Road

Brighton

LEXTONS / SALES
LETTINGS
AUCTIONS
COMMERCIAL



About the property

A stunning fully furnished period cottage set back from the road, situated in a popular residential location close to schools, nature walks, local shops and quick access to the A27.

The accommodation is beautifully presented and arranged over two floors with a lovely large living/dining room with log burner and modern kitchen with Neff appliances on the ground floor. To the first floor, there are two good sized double bedrooms and white suite shower room.

The property further benefits from allocated parking and a private garden which takes full advantage of the favoured Westerly aspect.

**Old London Road
Brighton**

£2,500 Per month



2

BEDROOM

1

RECEPTION

1

BATHROOM



SCAN HERE TO VIEW ALL AVAILABLE PROPERTIES



Ground Floor

Approx. 37.0 sq. metres (398.8 sq. feet)

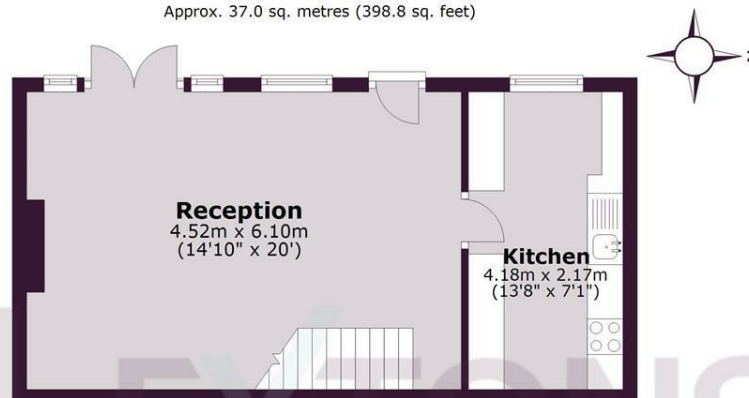

Reception
4.52m x 6.10m
(14'10" x 20')

Kitchen
4.18m x 2.17m
(13'8" x 7'1")

First Floor

Approx. 34.0 sq. metres (365.6 sq. feet)

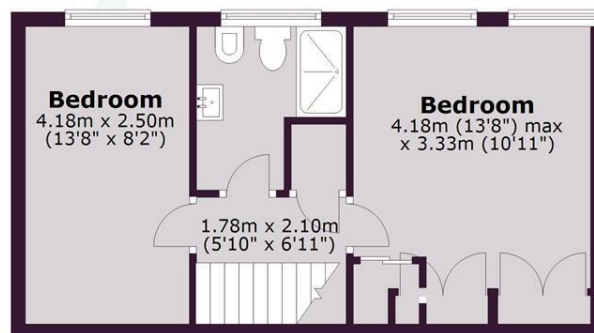

Bedroom
4.18m x 2.50m
(13'8" x 8'2")

Bedroom
4.18m (13'8") max
x 3.33m (10'11")

1.78m x 2.10m
(5'10" x 6'11")

Total area: approx. 71.0 sq. metres (764.4 sq. feet)

Energy Efficiency Rating		Current	Potential
Very energy efficient - lower running costs			
(92 plus) A			87
(81-91) B			
(69-80) C			
(55-68) D		56	
(39-54) E			
(21-38) F			
(1-20) G			
Not energy efficient - higher running costs			
England & Wales		EU Directive 2002/91/EC	