

Hartington Villas

Hove



About the property

Situated close to Hove Station in a lovely Edwardian property, is this well presented first floor rear converted studio apartment.

The flat has the additional advantage of a separate kitchen with modern appliances, a good size studio room with built in wardrobes and a modern bathroom with bath and shower.

With Hove station just a short walk away, commuting to Brighton, London, or other nearby areas is a breeze. Hove Park, a beautiful green space, is also within walking distance, providing an excellent spot for leisurely strolls, picnics, or outdoor activities.

This is a superb property in a fantastic location. In short, not one to be missed!

Hartington Villas Hove



0

BEDROOM

1

RECEPTION

1

BATHROOM



SCAN HERE TO OFFER ON THIS PROPERTY



First Floor

Approx. 32.1 sq. metres (345.7 sq. feet)

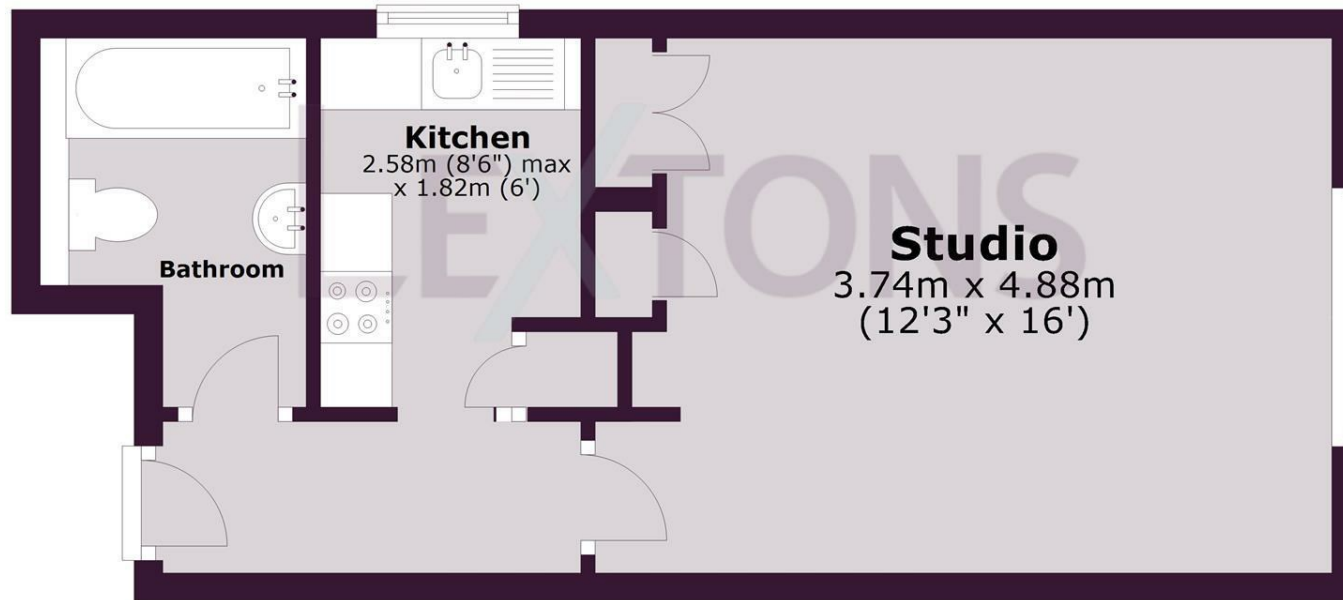

Total area: approx. 32.1 sq. metres (345.7 sq. feet)

Whilst every care has been taken to ensure accuracy, dimensions are approximate and for illustrative purposes only.

Created by Lextons. All rights reserved.

Energy Efficiency Rating		
	Current	Potential
Very energy efficient - lower running costs		
(92 plus) A		
(81-91) B		
(69-80) C	71	76
(55-68) D		
(39-54) E		
(21-38) F		
(1-20) G		
Not energy efficient - higher running costs		
England & Wales	EU Directive 2002/91/EC	

LEXTONS

Call our sales team to arrange a viewing appointment:

01273 56 77 66

174 Church Road, Hove, BN3 2DJ
hovesales@lextons.co.uk | www.lextons.co.uk