



Apartment 31 Maes Deri, Ewloe, Deeside, Flintshire, CH5 3UW

£85,000



EPC - null Council Tax Band - A Tenure - Leasehold

Maes Deri, Deeside

1 Bedrooms - Apartment - Studio

Purpose built ground floor studio apartment with one bedroom, living area, kitchenette, shower room, communal gardens, and allocated parking space. Tenure: Leasehold.
Council Tax Band: A. EPC Rating: TBC.



Accommodation

Composite front door leads into the living area

Living Area With Kitchen

14'3" x 11'7" (4.36m x 3.55)

Having a double radiator, power points, double glazed window to front - kitchen has worktop, integrated Zanussi oven, 2 ring electric hob, stainless steel sink with mixer tap, two small wall units, electric cooker point.

Shower Room

7'4" x 6'2" (2.24 x 1.90)

Having shower enclosure, pedestal wash basin, W.C., radiator, cupboard and plumbing for washing machine underneath.

Bedroom

10'2" x 7'10" (3.10 x 2.40)

Having a radiator, and a double glazed window overlooking the rear.

Outside

Having a communal gardens, seating areas and an allocated parking space.

Directions

Follow Chester St to Mold Byp/A494. Continue on A494 to B5125. Take the exit for B5127 from A494. Continue on B5125. Take St David's Park to Maes Deri where the property can be found.





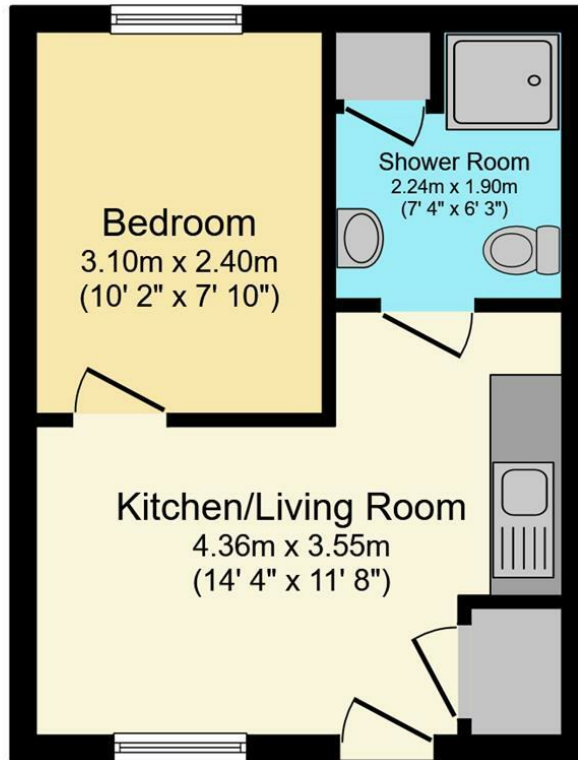

Floor Plan

Floor area 25.9 m² (279 sq.ft.)

TOTAL: 25.9 m² (279 sq.ft.)

This floor plan is for illustrative purposes only. It is not drawn to scale. Any measurements, floor areas (including any total floor area), openings and orientations are approximate. No details are guaranteed, they cannot be relied upon for any purpose and do not form any part of any agreement. No liability is taken for any error, omission or misstatement. A party must rely upon its own inspection(s). Powered by www.Propertybox.io

Energy Efficiency Rating

	Current	Potential
<i>Very energy efficient - lower running costs</i>		
(92 plus) A		
(81-91) B		
(69-80) C		
(55-68) D		
(39-54) E		
(21-38) F		
(1-20) G		
<i>Not energy efficient - higher running costs</i>		
England & Wales	EU Directive 2002/91/EC	

Call us on
01352 372111

Mold@williamsestates.com

Agents Note: Whilst every care has been taken to prepare these particulars, they are for guidance purposes only. All measurements are approximate and are for general guidance purposes only and whilst every care has been taken to ensure their accuracy, they should not be relied upon and potential buyers are advised to recheck the measurements themselves.