

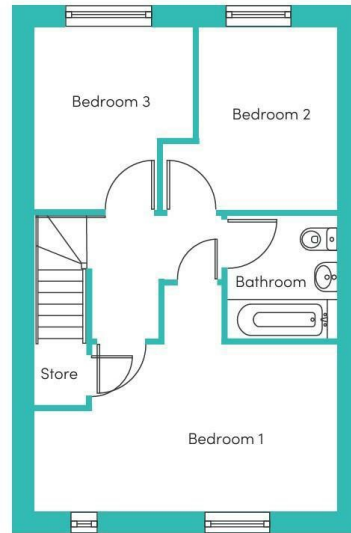

Lapwing Way | Whiteley | Fareham | PO15 7RN

£1,575 Per Month





| Energy Efficiency Rating | | |
|---|-------------------------|-----------|
| | Current | Potential |
| Very energy efficient - lower running costs | | |
| (92 plus) A | 97 | 97 |
| (81-91) B | | |
| (69-80) C | | |
| (55-68) D | | |
| (39-54) E | | |
| (21-38) F | | |
| (1-20) G | | |
| Not energy efficient - higher running costs | | |
| England & Wales | EU Directive 2002/91/EC | |



Description

W&W are delighted to offer for rent this brand new (Rendlesham) three bedroom mid terrace house. The property boasts three bedrooms, an impressively kitchen/dining room, lounge and downstairs cloakroom, and a modern family bathroom. The property also benefits from 'in our opinion' a good sized rear garden and allocated parking. Pets are considered at this property on an individual basis.

Key features

- Dishwasher
- Washing/Drying Machine
- Fridge/Freezer
- Security Alarm



H3 Whiteley Shopping Centre
 Whiteley Way
 Whiteley
 Hants
 PO15 7PD
 01489 580800
 pm@walkerwaterer.co.uk
 www.walkerwaterer.co.uk