

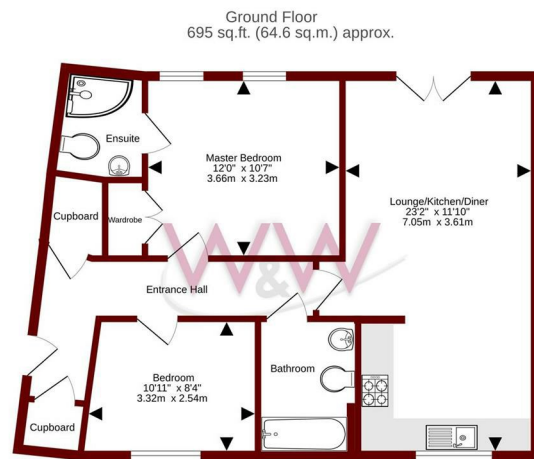

Lynn Crescent | | Titchfield Common | PO14 4FP

£1,150 Per Month





TOTAL FLOOR AREA : 695 sq.ft. (64.6 sq.m.) approx.
 Whilst every effort has been made to ensure the accuracy of the foregoing information, the responsibility of floors, dimensions, areas and any other facts are approximate and no responsibility is taken for any error, omission or misstatement. This plan is for guidance purposes only and should be used as a guide to the proposed purchase. The actual layout and dimensions may vary from the information given and no guarantee as to their accuracy or efficiency can be given.
 Based on Spaceplan 12/02

Energy Efficiency Rating		
	Current	Potential
Very energy efficient - lower running costs		
(92 plus) A		
(81-91) B		
(69-80) C		
(55-68) D		
(39-54) E		
(21-38) F		
(1-20) G		
Not energy efficient - higher running costs		
England & Wales	EU Directive 2002/91/EC	



Description

W&W are pleased to offer for rent this well presented two double bedroom first floor apartment. The property boasts two bedrooms, 23'2ft open plan kitchen/dining/living room, main bathroom & en-suite shower room to the main bedroom. The property also benefits from communal rear gardens and allocated parking.

Lynn Crescent is situated in the ever popular location of Titchfield Common the local shops and amenities of Titchfield & Locks Heath are both less than 2 miles away, while the local pub is just a short stroll. Transport links are easily accessible including A27 & M27.

Key features



H3 Whiteley Shopping Centre
 Whiteley Way
 Whiteley
 Hants
 PO15 7PD
 01489 580800
 pm@walkerwaterer.co.uk
 www.walkerwaterer.co.uk