

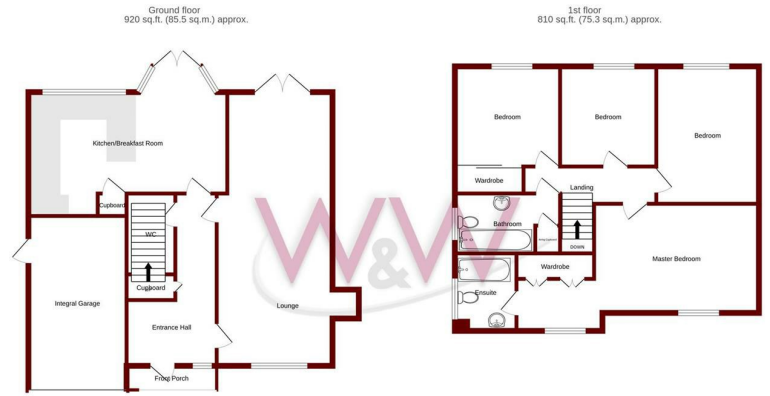

Roebuck Avenue | | Fareham | PO15 6TN

£2,100 Per Month





TOTAL FLOOR AREA: 1730 sq.ft. (160.7 sq.m.) approx.

Whilst every effort has been made to ensure the accuracy of the floorplan contained here, measurements of doors, windows, rooms and any other items are approximate and no responsibility is taken for any error, omission or mis-statement. This plan is for illustrative purposes only and should be used as such for any prospective purchase. The services, systems and appliances shown have not been tested and no guarantee as to their operability or efficiency can be given.
Made with Homestyler ©2024

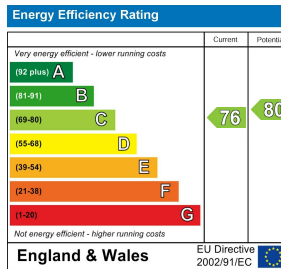

Description

W&W are please to offer for let this spacious and well laid out four bedroom, two bathroom family home offering excellent accommodation across two floors, with the added benefit of an integral garage and private rear garden.

The ground floor comprises a welcoming entrance hall with storage cupboards and a downstairs WC, a generous lounge with good natural light, and a well proportioned kitchen/breakfast room providing plenty of space for dining. There is also direct access to the integral garage, offering secure parking or additional storage.

Upstairs the first floor offers four bedrooms, including a spacious master bedroom with en-suite bathroom and built in wardrobe. The remaining bedrooms are well sized and served by a family bathroom.

Externally, the property benefits from a private enclosed rear garden, ideal for outdoor use, along with driveway and garage parking.

Please contact us to arrange a viewing on 01489580800

Key features



H3 Whiteley Shopping Centre
Whiteley Way
Whiteley
Hants
PO15 7PD
01489 580800
pm@walkerwaterer.co.uk
www.walkerwaterer.co.uk