

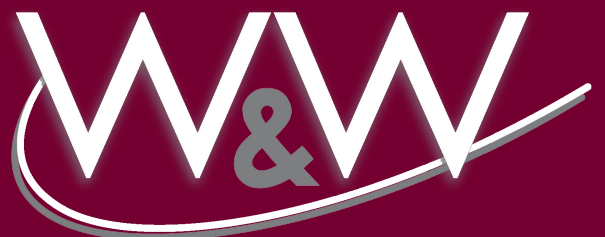

Lovage Road | | Whiteley | PO15 7LD

£1,200 Per Month

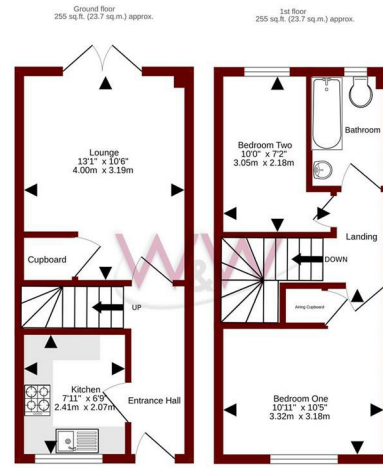



Energy Efficiency Rating		
	Current	Potential
Very energy efficient - lower running costs		
(92 plus) A		
(81-91) B		
(69-80) C		
(55-68) D		
(39-54) E		
(21-38) F		
(1-20) G		
Not energy efficient - higher running costs		
England & Wales	EU Directive 2002/91/EC	



Description

***Two Bedroom Mid Terraced House To Rent ***Allocated Parking ***Rear Garden ***Long Term Let Available
 Close proximity to Whiteley Shopping Centre and Solent Business Park *Book your Viewing Today

Key features

- Two bedroom Property
- Allocated parking
- Pet Friendly
- Near Shopping Centre
- Lounge/Diner
- Recently decorated
- Near Business Park
- Rear Garden



H3 Whiteley Shopping Centre
 Whiteley Way
 Whiteley
 Hants
 PO15 7PD
 01489 580800
 pm@walkerwaterer.co.uk
 www.walkerwaterer.co.uk