

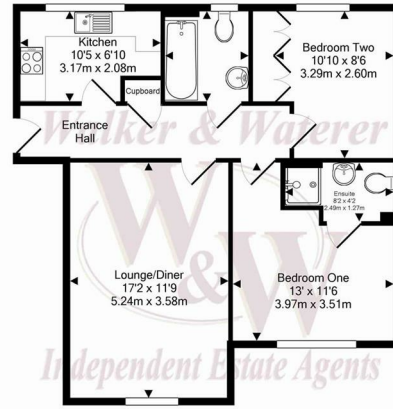

Coppice Court | Rowan Close | Whiteley | PO15 7GR

£1,100 PCM





Total Approx. Floor Area 656 Sq.Ft. (60.9 Sq.M.)
 Whilst every attempt has been made to ensure the accuracy of the floor plan contained here, measurements of doors, windows, rooms and any other items are approximate and no responsibility is taken for any error, omission, or mis-statement. This plan is for illustrative purposes only and should be used as such by any prospective purchaser. The services, systems and appliances shown have not been tested and no guarantee as to their operability or efficiency can be given.
 Made with Metropix ©2016

Energy Efficiency Rating		Current	Potential
Very energy efficient - lower running costs			
(92 plus)	A		
(81-91)	B		
(69-80)	C		
(55-68)	D		
(39-54)	E		
(21-38)	F		
(1-20)	G		
Not energy efficient - higher running costs			
England & Wales		EU Directive 2002/91/EC	



Description

Walker and Waterer are pleased to offer this well presented two double bedroom apartment to the rental market. Accommodation comprises of Kitchen, living room, bathroom, two bedrooms, one with en-suite shower room. Property also benefits from allocated parking. Call today to arrange your viewing. Property Available from the 28th April 2025

Key features

- TWO DOUBLE BEDROOMS
- ALLOCATED PARKING
- SPACIOUS LIVING ROOM
- GROUND FLOOR APARTMENT
- EN-SUITE SHOWER ROOM
- FITTED KITCHEN
- WALKING DISTNCE TO WHITELEY SHOPPING CENTRE



H3 Whiteley Shopping Centre
 Whiteley Way
 Whiteley
 Hants
 PO15 7PD
 01489 580800
 pm@walkerwaterer.co.uk
 www.walkerwaterer.co.uk