



Poplar Way | Hedge End | Southampton | SO30 0QB

£1,000 Per Month





Ground Floor
522 sq.ft. (48.5 sq.m.) approx.

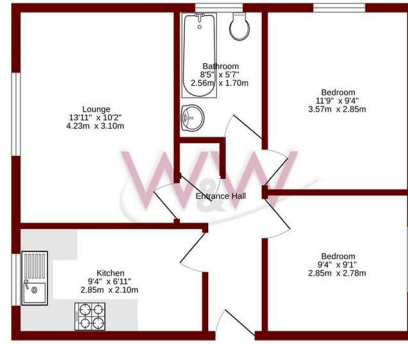

TOTAL FLOOR AREA: 522 SQ.FT. (48.5 SQ.M.) APPROX.
We warrant that the floor area is correct to the best of our knowledge and belief. We do not warrant the accuracy of the floor area measurements. The accuracy of the floor area measurements is dependent on the accuracy of the measurements taken and the accuracy of the calculations. The accuracy of the floor area measurements is dependent on the accuracy of the measurements taken and the accuracy of the calculations.

Energy Efficiency Rating		
	Current	Potential
Very energy efficient - lower running costs		
(92 plus) A		
(81-91) B		
(69-80) C		
(55-68) D		
(39-54) E		
(21-38) F		
(1-20) G		
Not energy efficient - higher running costs		
England & Wales	71	77
EU Directive 2002/91/EC		

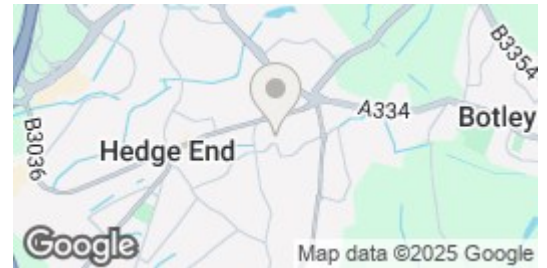

Description

Well presented, nice size, two double bedroom apartment to rent on a long term basis within the popular residential area of Hedge End. The property offers two double bedrooms a good sized living room, kitchen & family bathroom, whilst outside the property there is allocated parking for 2 vehicles.

Key features



H3 Whiteley Shopping Centre
Whiteley Way
Whiteley
Hants
PO15 7PD
01489 580800
pm@walkerwaterer.co.uk
www.walkerwaterer.co.uk