



7 Keats Close, Whiteley, PO15 7LP

Asking Price £675,000





Keats Close |

Whiteley | PO15 7LP

Asking Price £675,000

W&W are delighted to offer for sale this well presented & extended home with it's own one bedroom annexe. The property itself boasts five bedrooms, lounge, kitchen/breakfast room, dining room, two utility rooms, cloakroom, modern en-suite & modern main bathroom. The annexe enjoys a bedroom, lounge & modern bathroom. Externally the property also benefits from a rear landscaped garden, detached double garage & driveway parking.

Keats Close is ideally situated for family life with both Primary Schools within walking distance & senior school busses running locally, the train station is around a 20 minute walk with regular links to Fareham, Portsmouth & Southampton and other excellent transport links are easily accessible. Also just over a mile away is Whiteley Shopping Centre providing a variety of shops, eateries & amenities.







Well presented & extended family home situated in a popular quiet cul de sac location

The property boasts it's own one bedroom annexe

Welcoming entrance hall enjoying attractive wood effect laminate flooring flowing into the downstairs cloakroom & dining room

20'9ft Dual aspect lounge with centrepiece fireplace & double doors opening out onto the rear garden

Dining room with double doors into the lounge

Modern kitchen/breakfast room enjoying breakfast bar

Integrated appliances include double oven, hob, dishwasher & space for fridge/freezer

Utility room providing additional storage space, plumbing for washing machine/tumble dryer & built in single fridge

Downstairs cloakroom

Main bedroom benefitting from built in wardrobes & modern en-suite shower room

Three additional bedrooms

Modern main bathroom comprising three piece white suite & feature jacuzzi style spa bath

One double bedroom annexe with it's own modern bathroom & lounge with double doors opening out onto the rear garden

Rear enclosed landscaped garden laid to paved patio areas, lawn with display flowers/shrubbery & rear access

Detached double garage with driveway parking for multiple vehicles

Owned solar panels to the property

## ADDITIONAL INFORMATION

Property construction - Traditional brick built

Electricity supply - Mains & Solar Panel

Water supply - Mains

Sewerage - Mains

Heating - Gas central heating with two replacement boilers

Broadband - There is broadband connected to the property and the seller informs us that this is supplied by Virgin media with superfast cabling

Please check here for potential broadband speeds - <https://www.openreach.com/fibre-broadband>

The current seller informs us that they have mobile signal and are no current black spots. Please check here for all networks - <https://checker.ofcom.org.uk/>

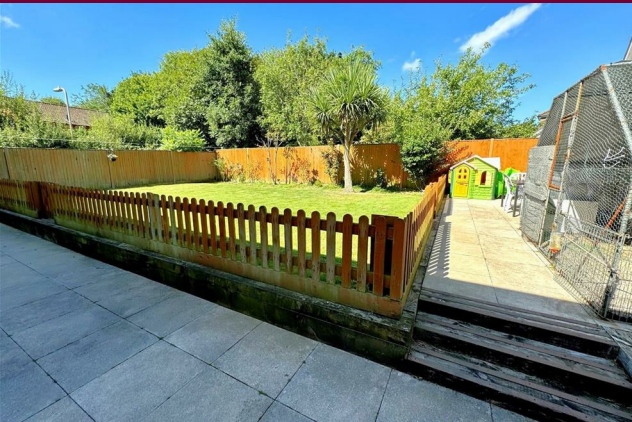

Ground floor  
1187 sq ft. (110.3 sq.m.) approx.

1st floor  
683 sq ft. (63.4 sq.m.) approx.

Garage  
317 sq ft. (29.5 sq.m.) approx.

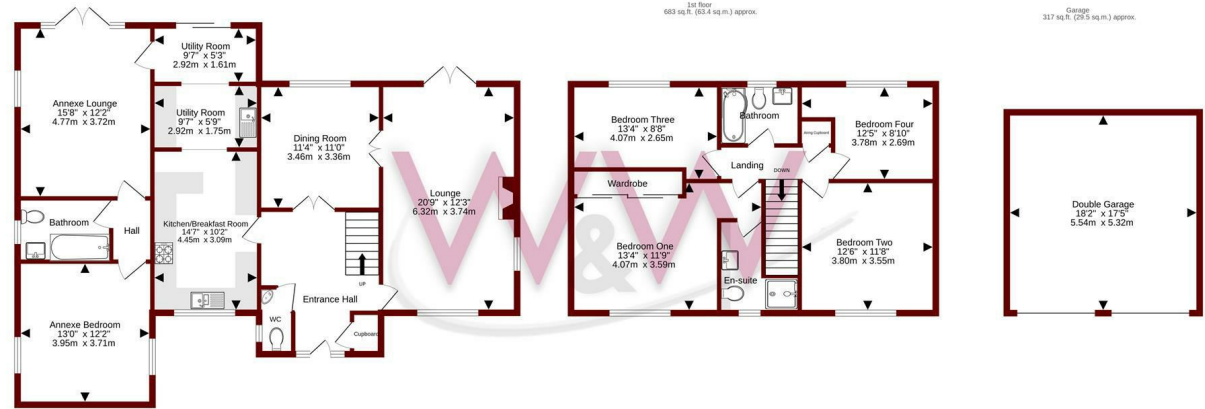

TOTAL FLOOR AREA : 2187 sq.ft. (203.2 sq.m.) approx.

Whilst every attempt has been made to ensure the accuracy of the floorplan contained here, measurements of doors, windows, rooms and any other items are approximate and no responsibility is taken for any error, omission or mis-statement. This plan is for illustrative purposes only and should be used as such by any prospective purchaser. The services, systems and appliances shown have not been tested and no guarantee as to their operability or efficiency can be given.

Made with Metropix ©2024

Energy Efficiency Rating		
	Current	Potential
Very energy efficient - lower running costs		
(92 plus) <b>A</b>		
(81-91) <b>B</b>	82	86
(69-80) <b>C</b>		
(55-68) <b>D</b>		
(39-54) <b>E</b>		
(21-38) <b>F</b>		
(1-20) <b>G</b>		
Not energy efficient - higher running costs		
England & Wales	EU Directive 2002/91/EC	

Council Tax Band - F - £2980 Per Annum

Tenure - Freehold

Current EPC Rating - B

Potential EPC Rating - B

H3 Whiteley Shopping Centre

Whiteley Way

Whiteley

Hants

PO15 7PD

01489 580800

whiteley@walkerwaterer.co.uk

www.walkerwaterer.co.uk