

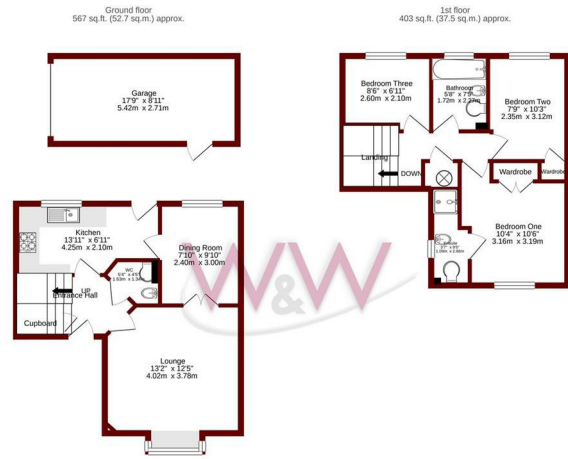

Orpine Close | | Fareham | PO15 5TE

£1,500 PCM





TOTAL FLOOR AREA: 970 sq. ft. (90.2 sq. m.) approx.
W&W are pleased to have been able to provide you with this information. However, we do not warrant the accuracy of the figures provided here. Measurements are taken to the best of our knowledge and are not intended to be used for any legal or financial purposes. The plans are for information only and are not intended to be used for any legal or financial purposes. The accuracy, content and availability of the information has been checked and is guaranteed to the best of our knowledge.

Energy Efficiency Rating		Current	Potential
Very energy efficient - lower running costs			
(92 plus)	A		83
(81-91)	B		
(69-80)	C		
(55-68)	D	66	
(39-54)	E		
(21-38)	F		
(1-20)	G		
Not energy efficient - higher running costs			
England & Wales		EU Directive 2002/91/EC	

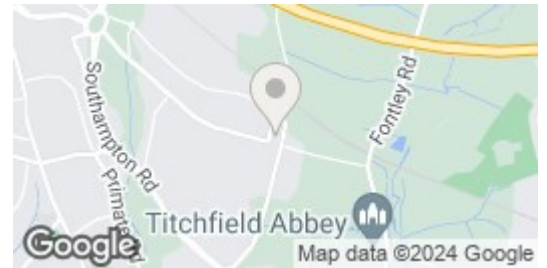

Description

Walker & Waterer are delighted to offer for rent this Detached Home In a Cul De Sac Location * Two Reception Rooms * Re-Fitted Kitchen * Three Bedrooms * Cloakroom, En-Suite & Family Bathroom * Detached Garage & Driveway * Attractive Frontage * Favoured Aspect Rear Garden * Available Late June 2024*

Key features

- Detached House
- Lounge
- Ensuite
- Downstairs Toilet
- Southerly aspect rear garden
- Three Bedrooms
- Dining Room
- Bathroom
- Detached garage



H3 Whiteley Shopping Centre
 Whiteley Way
 Whiteley
 Hants
 PO15 7PD
 01489 580800
 pm@walkerwaterer.co.uk
 www.walkerwaterer.co.uk